

2026 Canadian Community Psychology Conference

Community-Based Research and Practice and Beyond: Hope in Times of the Polycrisis



May 21–23, 2026

Wilfrid Laurier University
75 University Ave W, Waterloo, ON



TABLE OF CONTENTS

**** click on the title and it will take you to the respective page**

Land Acknowledgement	03
Funding Acknowledgement	04
Welcome Message	05
Memorial Address	06
Conference Organizing Committee	08
General Information and Session Politics	09
Map of Campus	14
Map of Science Building (N1001, N1002, N1044, N1057, 1059, Atrium)	15
Map of Bricker Academic (BA110, BA111, BA112)	16
Community Psychology Network	18
Call for Papers: AJCP	19
Program at a Glance	20
Daily Program Breakdown	21
Plenary Discussion: 50 Years of CP in Canada	25
Plenary Discussion: Alumni Panel CP Prace in the Field	29
Town Hall Collective Reflection I	32
Community Market	33
CP Evening Gala Schedule	34
Community Spotlights	36
World Cafe Collective Reflection II	38
Detailed Program with Abstracts	40

Land Acknowledgement

Laurier's Waterloo and Brantford campuses are located on the shared traditional territory of the Neutral, Anishnaabe (Anish-nah-bay) and Haudenosaunee (Hoe-den-no-show-nee) peoples. This land is part of the Dish with One Spoon Treaty between the Haudenosaunee and Anishnaabe peoples and symbolizes the agreement to share, protect our resources and not to engage in conflict.

From the Haldimand Proclamation of Oct. 25, 1784, this territory is described as: "six miles deep from each side of the river (Grand River) beginning at Lake Erie and extending in the proportion to the Head of said river, which them and their posterity are to enjoy forever." The proclamation was signed by the British with their allies, the Six Nations, after the American Revolution. Despite being the largest reserve demographically in Canada, those nations now reside on less than five per cent of this original territory.



Funding Acknowledgements

We would like to thank our funders for their generous support of this conference gathering:

Social Science and Humanities Research Council's Connection Grant Program

Social Science and Humanities Research Council's Canada Research Chair Program

Wilfrid Laurier University's:
Office of Research Services,
Alumni Association,
Faculty of Science, and
Department of Psychology





Welcome Message

On behalf of the Community Psychology program at Wilfrid Laurier University, we warmly welcome you to the Waterloo campus for the 2026 Canadian Community Psychology Conference. Laurier has been home to the largest English-speaking Community Psychology program in Canada for the last 50 years. As such, this gathering also serves as a celebration of the program's 50-year anniversary!

Our conference theme is "Community-Based Research and Practice in Canada and Beyond: Hope in the Times of Polycrisis," which sets our intention of centering the pivotal role of community-based work in helping us tackle some of the world's most pressing and intersecting issues.

This conference also serves as a gathering and space for connection for community-based leaders, practitioners, research scholars, student trainees, etc. as we aim to reinvigorate a network for interdisciplinary community-based scholarship, practice, and work across Canada and beyond.

We richly thank you for attending and wish you a wonderful conference gathering.

Ciann L. Wilson, Associate Professor and Conference Chair.
Wilfrid Laurier University.

In memory of Dr. Isaac Prilleltensky

Dr. Isaac Prilleltensky, a former member of the community psychology program at Laurier, was a Community Psychologist who was globally respected as a scholar, educator, administrator, and champion of human dignity and well-being (<https://www.professorisaac.com/>). He died on May 7, 2026 after a courageous battle with cancer. He was 66 years old. His wife of 43 years, Ora, died four days later of respiratory failure after enduring a physical disability resulting from Muscular Dystrophy. They have one son, Matan, who survives them.

Isaac was born in Cordoba, Argentina. He was 8 years old when both his parents died in an automobile accident. At age 16, he fled Argentina, where he experienced political repression and anti-semitism, and immigrated to Israel, where he met and married Ora. He completed his B.A. in Bar-Ilan University in 1980 and his M.A. in Tel Aviv University in 1983. Isaac and Ora moved to Winnipeg where Isaac learned English, completed his Ph.D. in Personality Psychology at the University of Manitoba, and worked at the Child Guidance Clinic of Greater Winnipeg.

From 1991–1999, Isaac was a faculty member in the Psychology Department at Laurier and a member of the Community Psychology program, where he supervised many CP students. After Laurier, Isaac moved to Victoria University in Melbourne, then Vanderbilt University in Nashville, Tennessee, and finally the University of Miami, where he became Dean of the School of Education and Human Development and then vice provost for Institutional Culture.

Isaac was a prolific researcher and theorist who authored 14 books and roughly 200 peer-reviewed journal articles and book chapters. According to Google Scholar, his works have been cited more than 20,000 times

(<https://scholar.google.ca/citations?user=TIGKsNYAAAAJ&hl=en&oi=ao>, May 13, 2026). His promise as a scholar was evident early on, as an article based on his dissertation entitled “Psychology and the Status Quo” was published in the American Psychologist in 1989. The dissertation, which received a laudatory appraisal from his external examiner, former APA President George Albee, was subsequently published as a book, *The Morals and Politics of Psychology* in 1994. He went on to make contributions to what he introduced as Critical Psychology and to Community Psychology, highlighting the importance of oppression, psychopolitical validity, social justice, primary prevention, wellness promotion, and mattering.

In memory of Dr. Isaac Prilleltensky

Within the field of Community Psychology, Isaac received several awards: the Seymour Sarason award for “groundbreaking, creative, and socially relevant work,” the award for Distinguished Contributions to Theory and Research in Community Psychology, and the John Kalafat award for Applied Community Psychology. From the Counseling Psychology Division of APA, he received the Lifetime Achievement Award in Prevention. Isaac was an invited keynote presenter at conferences in 27 different countries.

Beginning a lengthy contribution to administration, he was the Coordinator of the CP program at Laurier. At Peabody College at Vanderbilt University, he was Director of Graduate Studies in Human and Organizational Development. He was Scot Evans’ dissertation advisor and a mentor to Manuel Riemer, both of whom became faculty members in the Laurier CP program. He was the Dean of the School of Education and Human Development at the University of Miami, where he served with distinction for more than a decade. During his tenure, he launched innovative undergraduate and graduate programs, including a pioneering Ph.D. in Community Well-being. He later served as Vice Provost for Institutional Culture, further advancing initiatives centered on belonging, equity, and well-being, which inspired the creation of Laurier’s Collective Wellbeing Taskforce, co-led by Manuel.

Isaac was a creative and charismatic Community Psychologist who worked to promote social justice, prevention, and wellness promotion for people on the margins of society. He had an incredible ability to connect with people and mobilize them to work to better their communities and the lives of people in the community. Those of us who knew him will remember him not just for his accomplishments but for his character. Isaac was a person with exceptional integrity who treated everyone he met as someone who mattered. He was passionate for social justice, but he also had a great sense of humour. He was truly one in a million, and our CP program was lucky to have him as a faculty member for the first part of his career.

He mattered to us and will be greatly missed.

2026 Canadian CP Conference Organizing Committee



We would like to recognize the incredible commitment and hard work of all the members of our conference organizing committee who have helped to organize this year's event.



Ciann L. Wilson

Conference Chair

Wilfrid Laurier University, Centre for Community Research, Learning and Action (CCRLA)



Brittany Palmer

Conference Logistics Committee Chair

Wilfrid Laurier University, Viessmann Centre for Engagement and Research in Sustainability (VERIS)



Emily Escoffery

Conference Program Committee Chair

Wilfrid Laurier University, Viessmann Centre for Engagement and Research in Sustainability (VERIS)



Erin Dekker

Interim Organizing Committee Chair

Wilfrid Laurier University, Access & Equity Research Group



Jayashri Maraj

Interim Organizing Committee Chair

Wilfrid Laurier University, Access & Equity Research Group



Alexis Buettgen

Accessibility Coordinator

Wilfrid Laurier University, Viessmann Centre for Engagement and Research in Sustainability (VERIS)



John Sylvestre

University of Ottawa, Centre for Research on Educational and Community Services (CRECS),



Konrad Czechowski

University of Ottawa, Centre for Research on Educational and Community Services (CRECS)



Liesette Brunson

Professeure, Département de psychologie, Université du Québec à Montréal



Ela Desmarchelier

Wilfrid Laurier University, Viessmann Centre for Engagement and Research in Sustainability (VERIS)



Manuel Riemer

Wilfrid Laurier University, Viessmann Centre for Engagement and Research in Sustainability (VERIS)



Scott Neufeld

Brock University
Department of Psychology, CARE Collective



Adelaide Swanston

Wilfrid Laurier University

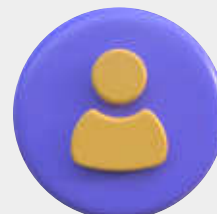

Julian Hasford

Toronto Metropolitan University

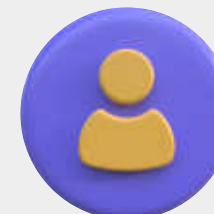

Rachel Persaud

Research Coordinator, Access & Equity Research Interest Group
Centre for Community Research, Learning and Action



Natalie Kivell

Wilfrid Laurier University

General Information



How to Use this Document

This document was designed to support you throughout this three day event. Some key features of this document:

- **Table of Contents** is hyperlinked. You are able to click on the title of the page in the list and it will directly take you to that page in the document.
- **Campus Map:** is annotated, indicating the primary campus buildings that will be used for this conference. On this page, an interactive map of the campus can be accessed by scanning a QR code. A copy of the QR code is also listed on this page which you can find below
- **Program at a Glance:** is hyperlinked. You are able to click on the name of the concurrent session and it will direct you to where this session is in the Detailed Program section, providing details on the presentation titles, presenter names and abstracts
- **Daily Breakdown and Detailed Program:** are both provided in this booklet, each outlining the location and time of presentations. Each program can be accessed separately on your device by scanning the QR code provided on the program pages, and is also provided below on this page.

**Interactive
Campus Map**
Scan below or click [here](#)



**Daily Breakdown
schedule**
Scan below or click [here](#)



**Detailed Schedule
with presenter
abstracts**
Scan below or click [here](#)



Things You Need to Know Document

We have compiled a comprehensive document that outlines in detail how to get around Wilfrid Laurier Campus and what to expect at arrival.

This document will have been sent to all registered attendees

General Information



Registration and Information Desk

Registration and information desk will be set up for the duration of the conference in the Science Building foyer. This is indicated with a star on the map. The desk will be open **May 21st to May 23rd from 8:00 am to 4:30 pm**

If you have any questions, folks at the information desk will be happy to help! Volunteers will also be present if you have any questions and will be wearing black t-shirts.

Lanyard and Name Tag

At registration, you will be given a lanyard with a name tag. When attending the conference over the three days, please wear this lanyard **at all times** so that organizers are aware that you have registered for the conference. **If you do misplace your lanyard please inform folks at the Registration Desk**

Dietary Restrictions

The catering provided at this event is based on the dietary restrictions that attendees indicated during registration. Signage will be displayed to clearly identify meals that meet specific needs, such as vegetarian, vegan, gluten-free and halal options. **We kindly ask that all participants be mindful and respectful of these accommodations.** If a meal is labeled for a particular dietary requirement, please allow those who rely on that option to select their food first. This helps ensure that everyone has access to items that are safe and appropriate for them.

Wi-Fi Access

When you visit the registration desk, there will be individual wifi codes available for you to use over the three day conference.

The registration and information desk will be in the Science Atrium (in front of the elevators) for the duration of the conference.

SAFEHawk App

The SAFEHawk official safety app of Wilfrid Laurier University. The app features emergency contacts, crisis alerts, location services features, in-app tip reporting, and much more!

General Information



Accessible Washrooms

Accessible washrooms are indicated on the campus maps. There are two accessible, stalled washrooms on the first floor of the Science Building, as well as three accessible and universal washrooms in the (Science Research Building) hallway connecting the Science Building and Bricker Academic Building.

Quiet Spaces

We have two designated quiet spaces, N1053 and an outdoor courtyard located on the southern side of the building. These spaces will serve as calm, low-stimulation areas where people can step away when needed.

NOTE: N1053 will be available at these times during the conference:

Thursday 8:30 am - 4:30 pm

Friday 8:30 am - 1:00 pm

Saturday 8:30 am - 4:30 pm

The courtyard will be open for the entire duration of the conference.

Smoke Free Campus

Smoking is prohibited in all buildings and grounds owned, leased or operated by the university, including:

- outdoor play areas
- athletic and recreational fields
- university residences and housing
- vehicles or equipment rented, owned or leased by the university

To learn more about Laurier's smoking policy follow this link:

<https://www.wlu.ca/about/governance/assets/resources/7.8-smoke-free-policy.html>

General Information



Photography at the Conference

A professional photographer will be present throughout the three day conference. By registering for and attending the conference, you are agreeing to be photographed during the event. This will help us document the conference and share highlights with our community and partners. The photographer will be primarily present at all first day panel sessions, as well as the CP Evening Gala, Community Maker Market, Community Spotlights and the World Cafe. After the event, all photos will be uploaded to a google drive. Photos belong to the conference attendees cannot ask for photos to be edited in a certain way

While our photographer will do their best to take photos of people who explicitly consent, we respect that some attendees may prefer not to be photographed at all. If you do not wish to appear in photos, please inform a conference staff member at the registration desk and speak directly with the photographer, Tim Campbell-Smith. A conference name tag will be used to indicate the photographer at the conference.

Tim Campbell-Smith will be the photographer for this event

Instagram: @timcampbellsms

Website: <https://www.timcampbellsmith.ca/photography-work>

May 21st Lunch Spots

The first day of the conference will have a 60 minute lunch break from **11:15 am - 12:15 pm**. This lunch break will **not** be catered. We have provided a list of spots that are in walking distance to campus.

Sultans Mediterranean Grill (Nut free & Halal options)
253 King St N Unit: FC2, Waterloo, ON N2J 2Y8

Potluck Caribbean Cuisine (Nut free options)
253 King St N, Waterloo, ON N2J 2Y8

Williams Fresh Cafe (Vegetarian options)
170 University Ave W, Waterloo, ON N2L 3E9

Famoso Italian Pizzeria - Waterloo (Nut free & Vegetarian options)
15 King St S, Waterloo, ON N2J 1N9

241 Pizza (Vegan Options)
258 King St N #1, Waterloo, ON N2J 2Y9

Second Cup Cafe
255 King St N #1, Waterloo, ON N2J 4V2

General Information



Session Room Protocols

- **Timing:** To ensure a smooth flow of the program, we kindly ask that attendees arrive at their session a few minutes early.
- **Cell Phones and other devices:** To maintain a respectful environment, we ask that attendees please silence all cell phones, tablets and other electronic devices during sessions. Please step outside of the room if a call must be taken.
- **Scent-free:** In consideration of attendees with allergies or sensitivities, this conference is a scent-free event. We ask that attendees refrain from wearing perfumes, colognes or other strongly scented products.
- **Closed Captioning:** will **NOT** be available in room's **N1042 and N1059**. Closed captioning will be available in all other presentation rooms.
- **ENG/FR Translations:** French translation will be available for select conference sessions through Zoom AI-translated closed captioning. Conference attendees who would like to access French translation can join the Zoom meeting for the session using their personal device (i.e., laptop, tablet, or smartphone). Volunteers will be available to assist conference attendees with setup if needed.
 - Once you have joined the Zoom meeting, please follow the steps below:
 - Turn on closed captions
 - Select **"More"**
 - Select **"Show Captions"**
 - Turn on **translated closed captions**
 - Select the **up arrow** beside "Hide Captions"
 - Select **"Caption Language"**
 - Select **"French (Canada)"**
 - Select **"Save"**
 - French-translated captions will then appear on your personal device screen throughout the session.

Hybrid Option: Thursday May 21st

We will be providing an online option for the first day keynote panels over Zoom (50 Years in Review, Alumni Panel, Townhall). To join the online call please use the link below:

<https://us02web.zoom.us/j/4233814794>

This option is available for the May 21st sessions **ONLY**. All other sessions will be in-person attendance only.

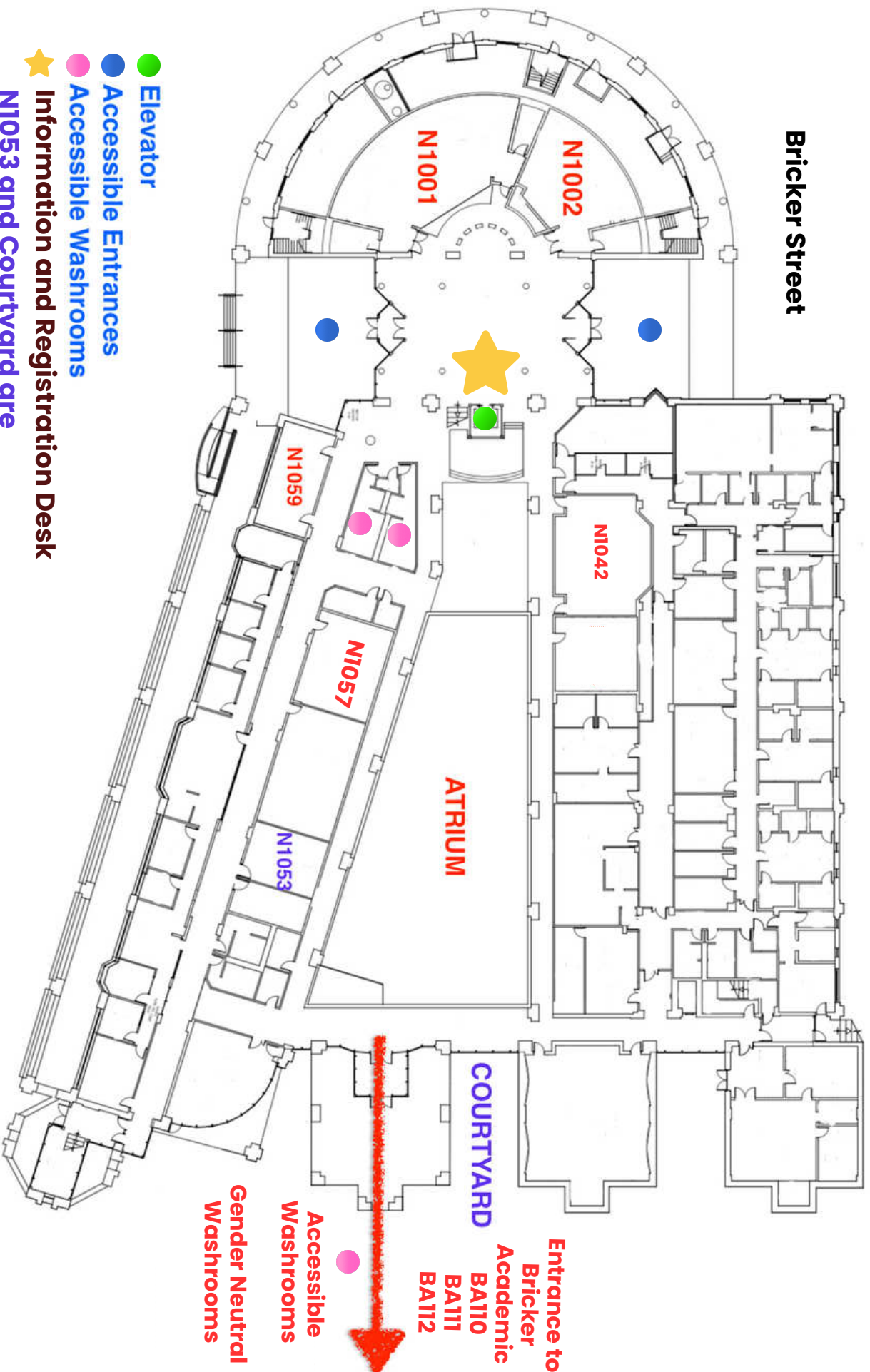

- Elevator
 - Accessible Entrances
 - Accessible Washrooms
 - ★ Information and Registration Desk
- N1053 and Courtyard are designated quiet spaces

**Balloons will be displayed to indicate conference spaces

Bricker Street

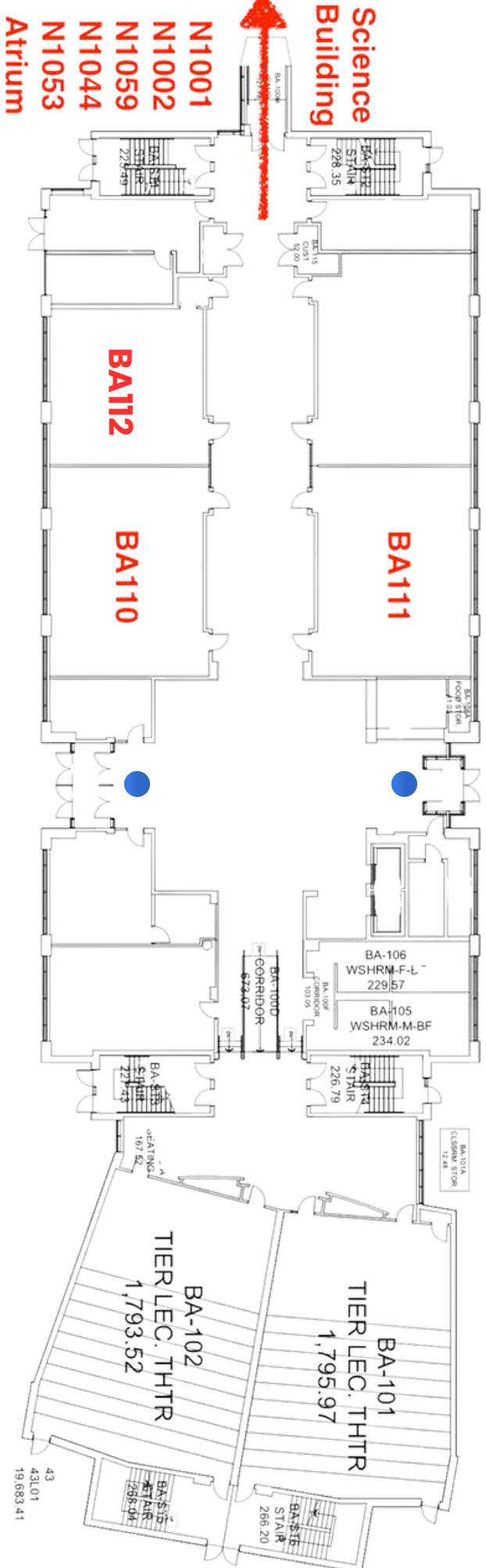

● Accessible Entrances

The CP50 History Document

Want to learn more about Community Psychology at Laurier?

This document chronicles the rich history of the Community Psychology (CP) program at Wilfrid Laurier University in Waterloo, Ontario, Canada, over the last 50 years. Drawing from an interview by Geoff Nelson and Mark Pancer with founding faculty member Ed Bennett and other historical sources, this document includes early and more recent developments, profiles of faculty members over the years, and key program features and their historical roots.

Click the link or scan the QR code below to access the document!

<https://researchcentres.wlu.ca/ccrla/assets/documents/2026-cp50-history.pdf>



Community Psychology Network

We're in the process of creating a national contact network called the CP Network to reconnect the community psychology community across Canada and beyond. The intention of the CP Network is to create a space for sharing opportunities, resources, and connections among institutions, student groups, faculty, practitioners, and community members affiliated with the field.

While the CP Network is grounded in a Canadian context, it's an open space and anyone with an interest in community psychology is welcome to join, both nationally and internationally. This is important, given the transnational nature of the issues we're facing across the globe, which community psychologists are well-positioned to help contend with.

If you'd like to join the CP Network and receive updates as it launches, please scan the QR code below and complete a short survey to indicate your interest and communication preferences:



Call for Papers

American Journal of Community Psychology Special Issue

The American Journal of Community Psychology invites submissions for a special issue: Hope in Times of Intersecting Crises: Community-Based Research and Practice in Complex Contexts.

This special issue is focused on the landscape of community psychology in the contemporary moment, as well as acknowledging 50 years of these conversations in Canada and beyond, hence the theme of this proposed special issue is Hope in Times of Intersecting Crises: Community-based research and practice in complex contexts and Hope in the time of polycrises. The proposed special issue will critically explore how the lived experiences of communities experiencing structural oppression and marginalization are embedded within this context as these crises disproportionately impact marginalized groups who are already experiencing various forms of systemic disenfranchisement, and how communities are increasingly engaged in forms of advocacy and activism to build broad public support for transformative system change.

This call for papers seeks scholarship and practice that highlights how communities, especially those facing marginalization and structural oppression, cultivate hope, resilience, and collective action in response to complex and overlapping crises. Submissions that are original quantitative, qualitative, and mixed methods research are welcome. This may include theoretical papers; empirical reviews; reports of innovative community programs or policies; and first-person accounts of stakeholders involved in research, programs, or policy, with a focus on underrepresented populations and issues of human diversity, social welfare, social justice, and human rights.

Journal special issue completion is estimated to be in December 2027



**FOR A DETAILED
TIMELINE AND MORE,
SCAN THIS QR CODE!**



Program at a Glance

** click on concurrent session for presentation abstracts and titles

Thursday, May 21 st 2026		Friday, May 22 nd 2026		Saturday, May 23 rd 2026	
8:30 am - 4:00 pm	Registration	8:00 am - 9:00 am	Registration/ Refreshments	8:00 am - 9:00 am	Refreshments and Opening
9:00 am - 11:15 am	Opening Remarks Opening Keynote Panel: 50 Years of CP in Canada A Half Century in Review	9:00 - 10:15 am	Concurrent Session 1	9:00 am - 10:15 am	Concurrent Session 5
11:15 am - 12:15 pm	Lunch (not catered)	10:30 am - 11:45 am	Concurrent Session 2	10:30 am - 11:45 am	Concurrent Session 6
12:15 pm - 1:30 pm	Alumni Panel Discussion: CP Practice in the Field	11:45 am - 12:45 pm	Lunch	11:45 am - 12:45 pm	Lunch
1:30 pm - 3:00 pm	Town Hall: Collective Reflection I	12:45 pm - 1:15 pm	Poster Session A	12:45 pm - 1:15 pm	Poster Session B
5:30 pm - 10:00 pm	Evening Gala	1:15 pm - 2:30 pm	Concurrent Session 3	1:15 pm - 2:30 pm	Concurrent Session 7
		2:45 pm - 4:00 pm	Concurrent Session 4	2:45 pm - 4:00 pm	World Cafe: Collective Reflection II
		4:00 pm - 5:00 pm	Community Spotlights	4:00 pm - 5:00 pm	ICCP Information

Daily Program Breakdown

Scan or click [here](#) for a copy of the Daily Breakdown schedule



NOTE: The following sessions on Day 1, May 21st will be recorded: 50 Years in Review, Alumni Panel and Town Hall: Collective Reflection I

DAY 1: Thursday, May 21st		
Times	Activity	Location of Activity
8:00 am - 4:30 pm	Registration Desk open <i>(coffee and tea service)</i>	Foyer close to Science Atrium
9:00 – 11:15 am	<u>Opening Ceremonies: Opening Remarks and Welcome</u> Moderator: Ciann L. Wilson Darren Thomas, Deborah MacLatchy, Jonathan Newman, Richelle Monaghan, and Paul Mallet <u>Memorial Address for Isaac Prilleltensky</u> Manuel Riemer, Geoff Nelson, and Scot Evans <u>Opening Keynote Panel Discussion - 50 Years of CP in Canada - A Half Century in Review</u> Moderator: Konrad Czechowski Panelists: Geoff Nelson, Ed Bennett, Francine Lavoie, Ed Pomeroy	N1001
11:15 am - 12:15 pm	Lunch (not catered)	
12:15 pm - 1:30 pm	<u>WLU Alumni Association Opening</u> <u>Alumni Keynote Panel Discussion: CP Practice in the Field</u> Moderator: Scott Neufeld Panelists: Nick Kerman, Nora Whitfield, Maryann Roebuck, Darren Thomas, Devon Fernandes	N1001
1:30 - 3:00 pm	<u>Collective Reflection Town Hall: Reinvigorating A Canadian CP Network Town Hall</u> Moderators: Ann Marie Beals and Emily Escoffery Closing	N1001
3:00 - 4:30 pm	Community Makers Market <i>(coffee and tea service)</i>	Science Atrium
5:30 - 10:00 pm	Evening Gala and CP50 Celebrations MCs: Maritt Kirst, Alexis Buettgen Music Performance: KW Sentro DJ: Ketan Shankardass Schedule 5:30 pm: Arrival and Mixer 6:00 pm: KW Sentro choir performance 6:15 pm: Opening and Welcome 6:30 pm: Dinner 7:30 pm: Dancing to the sounds of DJ Ketan	Fred Nichols Campus Centre, Turret

Daily Program Breakdown

Friday, May 22nd 2026		
Times	Activity *indicating primary presenter(s)	Location of Activity
8:00 am - 4:30 pm	Registration Desk Open <i>Refreshments</i>	Foyer/ Science Atrium
9:00 – 10:15 am	Concurrent Session 1	
	Session 1A: Artistic Presentations (Please see specific room numbers beside title names) <ul style="list-style-type: none"> Recovery Game Cafe: Autobiographical Game Design as a Creative Practice for Exploring Opioid Addiction Experiences (N1042) Arts of Resilience: Photovoice Insights on Cultural Identity and Coping Among Indigenous and Diaspora Communities (N1042) Understanding Filipino Canadian Identity and Thought to Combat the Polycrisis: Fascism, Ferdinand and Imelda Marcos, and What We Can Learn From Their Tyranny (N1042) Perspectives Toward Liberation and Practical Implications (N1057) Misdiagnosis as Psychiatrist Harm: Black Autistic Youth, Polycrisis, and the Possibility of Hope (N1057) Where the Land Remembers Us (N1059) 	N1042/N1057/N1059
	Thematic Overview: Health and Housing Session 1B: Lightning Presentations <ul style="list-style-type: none"> A Point-in-Time Estimate of Client Opioid Use in a Community Mental Health Setting Addressing Organizational Stigma in Electronic Health Records for People Who Use Drugs Early Implementation of Shelter Diversion Program for Youth Experiencing Homelessness in Ottawa The State of Mental Health Rights Violations in Outaouais (Québec) The Free-Flowing Model of Faith and Spirituality: A Framework for Culturally Responsive Care Between Support and Surveillance: The Care-Control Paradox in Transitional Housing for Youth Matrilineal Planning & Community Housing Alliances: Black-Indigenous Futures of Belonging and Care in a Time of Polycrisis 	N1001
	<ul style="list-style-type: none"> The Promise of Community Ownership: Case Studies in collective ownership of land and property North American Chinatowns: Urban Perspectives on Social Coexistence Co-Creating Knowledge: A Participatory Framework with Igorot (Filipino) Immigrants in Ontario 	
	Session 1C: Panel Presentation: From Participatory Action Research to Prioritizing Actions and Relationships – Transforming Community-based Researchers	N1002
10:15 – 10:30 am	Morning Break	
	Concurrent Session 2	
10:30 – 11:45 am	Session 2A: Panel Presentation: Connections in Precarity: Social Relationships Within Homelessness	N1001
	Session 2B: Panel Presentation: Community Psychology in Canada at the intersection of climate change, sustainability, and social justice	N1002
	Session 2C: Panel Presentation: About Us Without Us? Remediating Lived Expertise Exclusion With Community-Engaged Reviews of Research and Policy	BA111
	Session 2D: Workshop Presentation: Elizabeth Brunet and Francois Lauzier-Jobin	BA110
11:45 am - 12:45	Lunch (Catered)	Science Atrium
12:45 - 1:15 pm	Poster Presentation Session A Posters will be displayed for the entirety of the conference. Presenters will be available at their posters during the designated poster sessions. Please refer to <i>Poster Session A</i> and <i>Poster Session B</i> in the schedule to see which presenters will be available in each session. <ul style="list-style-type: none"> Relational Research through Indigenous Storywork: Principles and Practices Perceptions of Black Middle School Students' School Belonging: Exploring Related Factors and Influences The Role of Family Community Organizations in Shaping a Supportive Ecology Around English-Speaking Families in Quebec 	Science Atrium

	<ul style="list-style-type: none"> Equity in Every Cycle: Community Insights from a Menstrual Equity Pilot Program at Wilfrid Laurier University Preventative Care Through Psychology, Trauma and Oral Health Learning Emotion Focused Therapy for Youth: Clinician Experiences Across A Two-Day Training Cognitive Accessibility of Health Resources “This is a Societal Issue Not Just a Womxn's Issue”- Addressing the Impact of Vicarious Trauma in in Womxn-Dominated Nonprofit Gender-based Violence Services The Perception of Mental Health Resource Accessibility Among Youth Convicted of an Offence in Canada and the United States: A Scoping Review Facing Climate Change in Canada Carrying the Past, Navigating the Present: Indigenous Youth Perspectives on Foster Care and Homelessness 	
1:15 pm - 2:30 pm	Concurrent Session 3	
	Session 3A: Panel Presentation: Solutions to Homelessness: Research on Housing First Program Adaptations	N1001
	Session 3B: Panel Presentation: Advancing Social Prescribing in Canada: Evidence from Practice, Theory, and Policy	N1002
	Session 3C: Workshop Presentation: Stories Across Space & Time: Reflections on Thirty Years of Community Psychology Practice in Canada, Ghana, & Trinidad and Tobago	BA110
2:30 - 2:45 pm	Afternoon Break <i>Refreshments</i>	Science Atrium
2:45 pm - 4:00 pm	Concurrent Session 4	
	Session 4A: Panel Presentation: Breaking Barriers: Community-Based Research for Disability-Inclusive Employment	N1001
	Session 4B: Panel Presentation: Lived Expertise Engagement for Housing Justice	N1002
	Session 4C: Workshop Presentation: Ecological praxis and the future of community psychology : strategies, competences and ways to incorporate ecological system in our practices, teaching and professional development	BA111
4:00 pm - 5:00 pm	Community Spotlights O:se Kenhionhata:tie Land Back Camp, Social Development Centre Waterloo Region, Centre for Community Based Research	Science Atrium

Day 3 May 23rd 2026		
Times	Activity	Location of Activity
8:00 am – 9:00 am	Refreshments and Opening	Foyer/Science Atrium
9:00 – 10:15 am	Concurrent Session 5	
	Session 5A: Workshop Presentation: Workshopping World-Building: Abolitionist feminist pedagogical tools	BA110
	Thematic Overview: International and Diverse Communities Session 5B: Lightning Presentations <ul style="list-style-type: none"> Community Perspectives on Substance Use within the Caribbean population in the GTA An Arts-Based Process Evaluation of AFRO's Support Through the Generations Program Engaging Transformative Interdisciplinary and Intersectional Approaches in Community-Based Research in the African Diaspora Caregiver Engagement with the Culture of Sustainability at a Multicultural School Mental Health Experiences of International Students: The Effects of Status and Migratory Policy Change The Implications of Climate Change for the Learning and Development of Children and Youth Experiencing Poverty: Evidence from Educational Contexts Scholarship as Survival: Black Women Law Professors and Critical Interventions in Times of Crisis Schooling at the Margins: Anti-Racist Perspectives on Roma Youth, Exclusion, and Belonging 	N1001
	Session 5C: Panel Presentation: Studying Up and Fighting Back: Community-Engaged Research and Action Supporting People Experiencing Homelessness in St. Catharines, ON	N1002

10:15 – 10:30 am	Morning Break	Science Atrium
10:30 – 11:45 am	Concurrent Session 6	
	Session 6A: Panel Presentation: Awareness to Action: Understanding employers' motivations for building disability confidence	N1002
	Session 6B: Panel Presentation: Working Alongside Peer Researchers for Epistemic Justice: Examples from the Research Chair on the Reduction of Social Inequalities in Health	BA110
	Session 6C: Workshop Presentation: Opening Space for Applied Theatre in Community Research	BA111
	Thematic Overview: Mics./Relationships and Sexual Diverse Communities Session 6D: Lightning Presentations <ul style="list-style-type: none"> • “I’m not gonna offer you 5 terms that can boil down the gender experience”: Terminology for Transgender and Gender Diverse People in Research • How 2S/LGBTQ+ individuals experience talking about sexuality and gender with CisHet people • Creating Affirming Spaces for Transgender and Non-Binary Individuals During In-Person Research • Building Research Capacity in Community-Based Organizations: A case study with MAX Ottawa • Navigating serious mental illness and the liminal space created by being a 'patient' and researcher • Centring Survivor Voices: Intersectional Pathways to FGM/C and Mental Health Equity • Whose Evidence Counts? Aligning Peer Support With Community-Based Research to Resist Co-optation • Responding to Crises: What is the Value of Community-Based Research? 	N1001
11:45 am - 12:45 pm	Lunch (Catered)	Science Atrium
12:45 pm - 1:15 pm	Poster Presentation Session B Posters will be displayed for the entirety of the conference. Presenters will be available at their posters during the designated poster sessions. Please refer to <i>Poster Session A</i> and <i>Poster Session B</i> in the schedule to see which presenters will be available in each session. <ul style="list-style-type: none"> • The Art of Community: Community as an Act of Rebellion in Times of Polycrisis • Understanding and Addressing Eco-Anxiety Among Youth: Insights from a Scoping Review and Community Psychology Perspective • Where Community Meets Environment: Insights from a Preliminary Study of Sustainable Placemaking • Using Community-Based Research to Kickstart Grassroots Organizing and Advocacy: A Niagara Case Study • “I just want my kid to have a normal life”: paradoxes of care among providers and families of transgender and gender-diverse youth in Brazil • “The world is really not built for everyone”: A qualitative investigation of suicide risk among autistic transgender and gender diverse adults and the essential role of health care providers • Memes as Method: Exploring Alternative Tools to Engaging Youth in the Future of Sex Education • Improving Indigenous self-government: A collaborative case study with Bòdʒi ʔehdá First Nation 	Science Atrium
1:15 pm - 2:30 pm	Concurrent Session 7	
	Thematic Overview: Youth/Education Session 7A: Lightning Presentations <ul style="list-style-type: none"> • Listening to Community Voices: Reframing University–Community Partnerships Through a Mixed-Methods Study in the National Capital Region • Going beyond the transactional nature of community service-learning (CSL): Exploring relationships in community as a site of mutual learning and justice-doing • A Narrative Review of School-Based Mental Health Interventions • Reducing Barriers to Youth Mental Health Care Through a Brief, Community-Delivered EFFT Workshop • Community-Driven Resistance: Reimagining Youth Justice in Challenging Times • Identity Under Pressure 	BA111
	Session 7B: Panel Presentation: Newcomer Youth in Canadian Schools: Centering Voices and Building Belonging	BA110
	Session 7C: Workshop Presentations: Raising critical consciousness of colonialism as First Peoples: An interactive workshop on the process and the results of a partnership study	BA112
2:30 pm - 2:45 pm	Afternoon Break <i>Refreshments</i>	
2:45 pm - 4:00 pm	Collective Reflection II - World Cafe - Reinvigorating CP Network in Canada and Beyond Leo Wilton, Rich Janzen, Geraldine Palmer, and Ciann L. Wilson	Science Atrium
4:00 pm - 4:30 pm	<u>Info Session for the 11th Annual International Conference of Community Psychology</u> <ul style="list-style-type: none"> • Moshood Olanrewaju, 2026 ICCP Lagos, Conference Chair 	Science Atrium
	Closing	

50 Years of CP in Canada: A Half Century in Review

When: Thursday May 21st , approximately 10:00 am – 11:15 am EST

Where: Science Building, N1001

Moderator: Dr. Konrad Czechowski

This keynote panel discussion will centre the perspectives of scholars who have played a foundational role in establishing the field of Community Psychology in Canada. Panelists will reflect on key milestones and lessons learned throughout their career. By revisiting the field's history, the conversation will help situate where we are today, as we explore pathways for growth in community-based practice, advocacy and research in these times of polycrisis.

Featured Panelists:

Dr. Francine Lavoie, Dr. Geoff Nelson, Dr. Ed Bennett, Dr. Ed Pomeroy

Moderator

Dr. Konrad Czechowski

Konrad is a senior researcher at the Centre for Research on Educational and Community Services and a clinical faculty member in the Psychology department at the University of Ottawa. His work focuses on community-based research and program evaluation, with an emphasis on equity, inclusion, and capacity building. His research centers on the inclusion of trans and gender-diverse identities in research, sexual consent, communication and rejection, program development and evaluation, and issues related to homelessness and survival sex. He works closely with local community partners in Ottawa to ensure that research and evaluation are ethical, participatory, and responsive to real-world needs. Over the past decade, Konrad has partnered with community-based organizations in the Ottawa area on research and evaluation to develop and evaluate social service programs.



Panel Speakers

50 Years of CP in Canada: A Half Century in Review

Dr. Francine Lavoie

Francine Lavoie is an internationally recognized expert in violence prevention, and one of the founding community psychology faculty in Canada. She was the first woman to join the faculty of the School of Psychology in 1979 and the first researcher in Quebec to examine violence prevention in relationships among young people.



Professor Lavoie was appointed a Fellow by both the American Psychological Association and the Society for Community Research and Action in recognition of the quality of her scientific work. Throughout her career, she supported the development of two widely recognized violence prevention programs, ViRAJ and PASSAJ. Both programs have been implemented in Quebec, Ontario, Belgium, France and Peru and continue to be a model for effective violence prevention interventions. ViRAJ was nominated one of the ten best illustrations of impact of social science research in Quebec (Fonds de recherche du Québec, 2013). Among her contributions, she co-conducted the first survey on sexual and physical violence among the Inuit of Nunavik.

Dr. Ed Pomeroy

Ed Pomeroy is an early founder of Community Psychology in Canada. He received his PhD in Clinical Psychology from the University of Colorado, Boulder in 1968. He taught for two years at Laurentian University in Sudbury and came to Brock University in 1970 teaching clinical and community focused courses until he retired in 2005. From 1996 to 2001, Dr. Pomeroy served as the Editor of the Canadian Journal of Community Mental Health. His community service in the field of community mental health and community psychology has also been extensive including service on the national board of the Canadian Mental Health Association (CMHA) and involvement in a series of endeavours characterised as "Building a Framework for Support", a community focused approach to mental health policy. Dr. Pomeroy was recognized for his significant volunteerism by CMHA and also the Canadian Psychology Association (CPA). In 2001 he was the recipient of the CPA's award for "Distinguished Contributions to Public or Community Service".

Panel Speakers

50 Years of CP in Canada: A Half Century in Review

Dr. Geoff Nelson

Geoff Nelson's research has focused on community mental health programs for adults with serious mental illness and primary prevention programs for young children and families. His positive contributions have shaped both the field of community psychology and the wellbeing of communities across Canada. He has served as the Senior Editor of the Canadian Journal of Community Mental Health and Chair of the Community Psychology Section of the Canadian Psychological Association. As well, he was a member of the research teams for "Better Beginnings, Better Futures," a primary prevention program for children, and "At Home / Chez Soi," a longitudinal study of Housing First for people experiencing homelessness and mental illness in five Canadian studies. His contributions have been recognized by numerous awards including the Harry McNeill Award for Innovation in Community Mental Health from the American Psychological Foundation and the Society for Community Research and Action. In 2013, he received the award for Distinguished Contributions to Community Psychology Theory and Research from the Society for Community Research and Action. From 2004-05, he was Laurier University Research Professor, and in 2016, he received the first Laurier Award for Service Excellence and Community Engagement. According to Fortin-Pellerin et al. (2007), he was the most published author in the Canadian Journal of Community Mental Health, as of 2007, and, according to Ruesnik and Jason (2023), Journal of Community Psychology, he ranks 8th in the all-time number of publications in the two major U.S. community psychology journals: the American Journal of Community Psychology and the Journal of Community Psychology.



Panel Speakers

50 Years of CP in Canada: A Half Century in Review

Dr. Ed Bennett

Ed Bennett is a contributing author to one of the first books on community psychology in 1966, *Psychology in Community Settings: Clinical, Educational, Vocational, Social Aspects*, initiated the first community psychology courses and field placement experiences at WLU in 1971, and the community psychology MA program in 1976. He served as the program's director for many years. In his 34 years at WLU, he played a leadership role in advocating for many community-based prevention and health promotion policy initiatives and in taking action - research and development initiatives, including the creation of 17 settings, (all but two alive and well in 2026) . He served as Chair, Canadian Psychological Association, Public Policy Committee, 1973-1976; Chair, Canadian Mental Health Association (CMHA), Waterloo Region, 1974-1976; and Chair of the CMHA Ontario Division 1976-1978; Member, Mental Health Advisory Committee, Health and Welfare Canada, 1974-1976; Trustee, Ontario Mental Health Foundation, 1978-1984; and Trustee, Clarke Institute of Psychiatry, 1980-1982. During the 1980s, Ed served as the co-founder (1981) and co-editor (1981-1990) of the *Canadian Journal of Community Mental Health (CJCMH)*; and edited three scholarly books including, *Social Intervention Theory and Practice* (1987). In 1989, with MA student Mary Sehl and others, he co-founded Sand Hills Co-operative Homes Inc., a 6.5 million dollar housing project for newcomers to Canada. During the 90s until his retirement from WLU in 2005, and beyond, he served as the founder of several CBED initiatives, including the purchase and revitalization of two century-old industrial plants. Almost all of this work has been done in collaboration with the Old Order Amish of Ontario. One can obtain a flavour of this work in: *Emancipatory Responses to Oppression: The Template of Land-Use Planning and the Old Order Amish of Ontario*, *American Journal of Community Psychology*, Vol 31, Nos.1/2, March 2003. Ed retired in June, 2005, and was awarded Professor Emeritus status at WLU, July 1, 2005.



Alumni Panel: CP Practice in the Field

When: Thursday May 21st, 12:15 pm – 1:30 pm EST

Where: Science Building, N1001

Alumni from CP programs across Canada will come together to reflect on their training, career paths and the impact of CP across a range of fields. Panelists will explore how CP training can better prepare future practitioners for emerging challenges they are seeing within their respective field.

Featured Panelists:

- Dr. Darren Thomas, *Wilfrid Laurier University*
- Devon Fernandes, *Wilfrid Laurier University*
- Nora Whitfield, *Wilfrid Laurier University*
- Dr. Nick Kerman, *University of Ottawa*
- Dr. Maryann Roebuck, *University of Ottawa*

Moderator

Dr. Scott Neufeld

Dr. Scott Neufeld is an Assistant Professor of Community Psychology at Brock University and works with students and colleagues in the Community Action Research and Ethics (CARE) Collective on research, organizing and knowledge mobilization. Originally from the west coast, he completed his PhD in the Social Psychology of Substance Use Stigma at Simon Fraser University in 2023. Since moving to the Niagara region of Ontario in 2021 he has been privileged to continue to learn, research, and teach on qualitative research methods, community-based research, and ways of better understanding and addressing stigma, discrimination and exclusion facing people who use drugs and people who experience homelessness. This work is often in collaboration with people who have lived and living experience of substance use, homelessness and mental health. In 2024 he helped to co-found the Niagara Advocates with Lived and Living Experience (NALE) and currently serves as its co-chair University, Department of Psychology, CARE Collective



Panel Speakers

Alumni Keynote: CP Practice in the Field

Wilfrid Laurier Alumni Association (WLUA)

The WLUA is dedicated to its mission of providing leadership and value to the university community, alumni and future alumni. Through events, mentorship, volunteer opportunities and ongoing collaboration with university partners, the Association aims to build a supportive network that extends beyond graduation.



Dr. Darren Thomas

*VP. Indigenous Initiatives; Associate professor.
Indigenous Studies Laurier University*

Dr. Darren Thomas is Bear Clan and a member of the Seneca Nation who resides at the Grand River Territory of the Haudenosaunee. Darren graduated his MA 2013, his PhD 2020 in the community psychology program and currently serves as the Associate Vice-President of Indigenous Initiatives and is also an Associate Professor in the Indigenous Studies Program at Wilfrid Laurier University. Darren's research interests are: Indigenous thought and philosophy, Indigenous community development, strengthening and improving Indigenous health and well-being, Indigenous law, and Indigenous rights and resource governance.



Dr. Maryann Roebuck

*Canadian Mental Health Association, Ottawa Branch AND School of Centre for
Research on Educational and Community Services (CRECS), University of Ottawa*

Dr. Maryann Roebuck completed her PhD in Experimental Psychology (Community) at the University of Ottawa. She is currently the Director of Research and Housing at the Ottawa Branch of the Canadian Mental Health Association, a community-based mental health and Housing First organization. She is a mixed methods researcher with expertise in program evaluation, community mental health intervention research, and leveraging data to inform frontline decision-making. When she's not at CMHA Ottawa she teaches at the University of Ottawa and supervises learners in community contexts, conducts virtual Housing First fidelity assessments, and supports other mental health and housing agencies to meet their research and evaluation needs. In a past career she worked as a social policy analyst with the Government of Canada.

Panel Speakers

Alumni Keynote: CP Practice in the Field

Norah Whitfield

*Vice President, Federation Excellence and Community Impact,
Canadian Mental Health Association, National Office*

Norah Whitfield has extensive experiences practicing CP in the non-profit sector at the national and local level. These include her roles as Vice President Federation Excellence and Community Impact at the Canadian Mental Health Association, Vice President of Network Development and Member Services at Big Brothers Big Sisters Canada, Principle Research and Evaluation Consultant for Taylor Newberry Consulting, and founding Coordinator of the Community Research Ethics Office based in Waterloo Ontario. Her experience spans applied community-based research, as well as program and systems design and evaluation at the national, provincial, and municipal levels. She has worked across the charitable sector with national non-profits, health and social service organizations, corporate partners, and granting foundations. Through both focused, community-level initiatives and large-scale national projects, Norah brings a clear understanding of current challenges and emerging opportunities. She is known for strengthening the capacity of community organizations, supporting a high-quality charitable sector that operates with integrity, accountability, and long-term sustainability.

Dr. Nick Kerman

*University Health Network 's Gattuso Centre for Social Medicine;
Centre for Addiction and Mental Health; Fairmarc Psychology Centre*

Nick Kerman (He/Him) is a Psychologist registered in Ontario and completed his PhD in Clinical Psychology at the University of Ottawa. He currently works as a researcher affiliated with two Toronto academic hospitals where he specializes in mixed-methods research focused on homelessness, housing interventions, and community mental health and substance use services. As a clinician, Nick works with individuals experiencing substance use and concurrent disorders, emotional dysregulation, and occupational and relational difficulties. He also has experience working as a program evaluator, focusing primarily on supportive housing and community mental health services.



Devon Fernandes

Sr. Sustainability Integration Manager at Definity Financial Corporation; Founder, KW Library of Things

Devon Fernandes (he/him) completed his Master's in Community Psychology at Wilfrid Laurier University and now integrates sustainability into operations and insurance products at Definity Financial Corporation. Devon previously founded the KW Library of Things – a space where community members can borrow infrequently used items, like camping gear, instead of buying it new and also provides inclusive employment opportunities.

Town Hall

Collective Reflection I: Reinvigorating A Canadian CP Network Town Hall

When: Thursday May 21st , 1:30 pm - 2:45 pm EST

Where: Science Building, N1001

Throughout the conference, we will have collective reflections to speak to the role of community psychology as a field during the time of polycrisis.

Dr. Ann Marie Beals

Ann Marie Beals (nek'm/they/them) is a Two-Spirit Afro-Indigenous L'nu'k scholar, educator, and community organizer from Mi'kma'ki, the ancestral and unceded territory of the Mi'kmaq People. They are an Assistant Professor at Wilfrid Laurier University, located on the traditional territories of the, Anishinaabe, Haudenosaunee and Neutral Peoples.



Ann Marie is the founder of Wele'g Dwennimmen, an academic and community-based institute dedicated to Afro-Indigenous, Black, and Indigenous ways of being and knowing, with an emphasis on health and wellbeing. Their scholarship and community work centre Indigenous Afrikan and Indigenous Turtle Island knowledges, survivance, and relational governance. They emphasize care for our Earth Mother, intergenerational responsibility, and the ways Black and Indigenous communities sustain cultural continuity while resisting colonial erasure. Through storytelling, land-based learning, and community collaboration, Ann Marie advances liberatory futures rooted in solidarity, self-determination, and collective wellbeing.

Emily Escoffery

Emily Escoffery (she/her) is a second year masters student in the Community Psychology program at Wilfrid Laurier University. In partnership with the Social Development Centre, her current research focuses on climate resilience and the critical role of lived expertise and grassroots mobilizing in climate conversations. She has done past work in program evaluation and development with the PEI Adult ADHD Clinic and the Measurement4Change Pilot Evaluation Program. A particular project that drew her to community-based practice and learning was through her lead role in opening the Dorchester Community Fridge at Moving Forward Co-Operative in New Brunswick. Through her work, relationships and lived experience, she continues to recognize the importance of collective care networks and capacity building in addressing complex interconnected social issues. She will be continuing on into her PhD in Community Psychology at Laurier in Fall 2026.





Community Makers Market

When: Thursday, May 21st 2026, 3:00 pm – 4:30 pm

Where: Science Atrium

We are excited to be hosting a Community Makers Market to close out our first day of our conference. This market will feature local vendors from across the KW Region.

If you are interested in support our local vendors, we strongly encourage you to bring **cash** to purchase items.

We hope to see you there!



PLEASE BRING CASH





CP Evening Gala

When: Thursday, May 21st 2026, 5:30 pm - 10:00 pm

Where: 3rd Floor Turret, Fred Nichols Campus Centre

Attire: Semi-formal, though guests are warmly invited to attend in whatever style feels right for them.

The CP Evening Gala is a celebratory event marking the closing of our first day with food, music and dancing! This formal evening will open with a special welcome performance by KW Sentro.

The Gala is being held in the Turret, located on the **3rd floor of the Fred Nichols Campus Centre**. You can find an elevator on the left, when you enter the building.

There will be a registration desk/check-in table before you enter the Turret. When you check in at this table, you will be provided with your drink and meal ticket for the night. **Please note that everyone will receive 1-2 free drink tickets here. After that, you may purchase additional beverages from the card/interact only bar (i.e. no cash).**

The schedule for the CP Evening Gala is listed below. **Doors will open at 5:30 pm.**

Time	Activity
5:30 pm - 6:00 pm	Arrival, Registration, and Mixer
6:00 pm - 6:15 pm	KW Sentro Choir Performance
6:15 pm - 6:30 pm	Opening and Welcome
6:30 pm - 7:30 pm	Dinner
7:30 pm - 10:00 pm	DJ Ketan and Dance Floor





CP Evening Gala

When: Thursday, May 21st 2026, 5:30 pm – 10:00 pm

Where: Fred Nichols Campus Centre, Turret

KW Sentro

KW Sentro, also known as the Kitchener-Waterloo Centre for Filipino Canadian Music, Language, and Culture, is a charitable, non-profit organization located in Kitchener-Waterloo, Ontario. For the last 3 years, KW Sentro's choirs have performed extensively throughout the Waterloo Region and beyond and have written, staged, and produced originally composed "Sarswela", a form of Spanish theatre that found popularity in the Philippines in the early 1900s. Our kids and adults engage with music education in a way that allows each chorister to connect with their Filipino identity, developing a lived, critical, and embodied practice of healing and critical consciousness raising.



To learn more about us and our mission, please visit our website at www.kwsentro.com.

Dr. Ketan Shankardass

Ketan is a long-time record collector and selector who believes in the strong connection between music and wellbeing. On the side, he teaches in the Department of Health Sciences and leads the Health Equity Systems Interventions lab at Wilfrid Laurier University.



Community Spotlight

When: Friday, May 22nd, 4:00 pm – 5:00 pm

Where: Science Atrium

As part of the CP50 Celebration and the 2026 Canadian Community Psychology Conference, we're honoured to partner with 3 local community organizations for our conference Community Spotlight that have all had long-standing relationships with the CP program:

- O:se Kenhionhata:tie – Land Back Camp
- Social Development Centre Waterloo Region
- Centre for Community Based Research

On the second day of our conference (May 22nd) at 3:30 pm, leaders of these local organizations will be at tables in the Science Atrium and they will be present to speak to their ongoing work. Through these conversations, attendees will have the opportunity to gain a deeper understanding of the ongoing advocacy work and forms of community-based care across the region.



O:se Kenhionhata:tie Land Back Camp

Willow River Centre, otherwise known as Land Back Camp is an Indigiqueer, Two Spirit, trans and non-binary space for urban Indigenous youth and settler LGBTQ+ allies. They provide access to resources, Two Spirit teachings and programming, and local advocacy for 2SLGBTQ+ issues and Indigenous sovereignty for the FNMI queer community. They work closely with Black and Racialized communities as liberation is bound together. They work closely with grassroots organizations in Waterloo Region to call for Land Back. They are celebrating nearly 3 years at Willow River Centre, the first and only 2S Indigiqueer led organization in Waterloo Region

Website: www.landbackcamp.com

Facebook: www.facebook.com/osekenhionhatatie

Instagram: @ose.kenhionhatatie

Email: ose.kenhionhatatie@gmail.com



Social Development Centre
WATERLOO REGION

Social Development Centre Waterloo Region

The SDC is a non-partisan learning organization that supports the creation of community-wide solutions, ensuring that lived experience is the basis for collective action towards change in policies and service delivery. Their vision is fair and equitable access to social, economic, and political life for everyone in Waterloo Region. Over the years, the SDC has incubated countless community projects, grassroots groups, and other non-profits. Today, their primary pillars are Housing & Homelessness, Grassroots Infrastructure, and Lived Expertise. Their service programs include Civic Hub Waterloo Region, Eviction Prevention Peer Support, Festival of Neighbourhoods, and their Lived Expertise Program (which partners with the Region of Waterloo on the Plan to End Chronic Homelessness)

Website: <https://www.waterlooregion.org/>

Facebook: <https://www.facebook.com/sdcwr>

Instagram: @sdc.wr

Email: sdcw@waterlooregion.org



CENTRE FOR
COMMUNITY
BASED RESEARCH

Centre for Community Based Research

Established in 1982 by a group of academics and social advocates, John Lord, Peggy Hutchinson, and Harvey Savage the Centre for Community Based Research (CCBR) is a non-profit organization that does community-based research, program evaluation, community mobilization, and training. It is located on the University of Waterloo campus, and has sourced funding for and executed over 450 projects on a range of societal issues in collaboration with diverse equity-seeking groups. These projects include either conducting community-based research (e.g., evaluation, needs assessment, policy research), or promoting community-based research (e.g., capacity-building for non-profits, institutions, government, and students).

CCBR is committed to social justice and to building communities that are responsive and supportive, especially for people with limited access to power and opportunity. It conducts and promotes research, training and evaluation that is community-driven, participatory, and action-oriented. These principles guide us throughout all stages of our projects, including proposal development and grant writing.

Website: <https://www.communitybasedresearch.ca>

Email: general@communitybasedresearch.ca

World Cafe

Collective Reflection II: Reinvigorating A Canadian CP Network World Cafe

When: Saturday, May 23rd , 2:45 pm – 4:00 pm EST

Where: Science Building, Atrium

The World Cafe will bring conference attendees together to reflect on what they have learned throughout the conference, using this closing reflection space to think collectively about what meaningful action looks like in the midst of the polycrisis. We invite attendees to collectively explore what our responsibilities are as researchers, practitioners, community members and to imagine how we can collaborate in our networks to carry this momentum forward and sustainably support one another as we part ways.

We will be exploring the following questions together:

- Beyond a formalized CP network, how else might we restore a sense of community connectedness in the midst of societal/political polarization, and establish belonging among people who are social justice-minded?
- How do we cultivate space to support community based research and work?
- What are the ways we can better cultivate space for systemically marginalized people in our communities, institutions, and networks, such as Black, Indigenous, and racialized folks, 2SLGBTQ+ folks, disabled folks, etc.? How do we nest this work in ethical engagement and epistemic justice?
- What is the role of community-based research practice and community partnerships in the future we want to build in Canada and beyond?
- How do we build a CP network of practitioners, researchers, students etc. in Canada and beyond? What does it look like? How do we stay connected? Is this institutionally or systemically bound? How could this network be used to best support your work?

Moderators

Dr. Leo Wilton



Leo Wilton, Ph.D., is a Professor in the Department of Human Development at the State University of New York at Binghamton, USA. His research engages the complexities of how socio-structural and cultural contexts influence people's development and well-being within African and African diaspora communities, with specific implications for developing culturally-informed systems of care. In this context, the overall objective of his scholarly research program, incorporating an implementation science framework, has been to examine socio-structural and cultural factors that provide the basis for the development of multi-level, evidence-based, culturally congruent prevention and care interventions in Black communities.

World Cafe

Collective Reflection II: Reinvigorating A Canadian CP Network World Cafe

Dr. Rich Janzen

Rich Janzen is Executive Director of the Centre for Community Based Research, a non-profit organization located on the University of Waterloo campus. He sees research as a tool for social innovation and change - to collaboratively find ways so that people with limited access to power and opportunity can live equitably within community.



Rich has an academic background in community psychology and religious studies. He is an Adjunct Associate Professor at Conrad Grebel University College at the University of Waterloo. He is also part-time Associate Field Education Professor at the Faculty of Social Work, Wilfrid Laurier University. Rich has been involved in many (over 150) community-based research and knowledge mobilization projects. These projects have focused on a range of issues including immigrants and refugee newcomers, community mental health, disabilities, peace and conflict, family support, and faith and justice. This breadth of work has involved multi-partner research initiatives, program and systems change evaluation, and needs assessment with direct policy impact. He is author of over 45 academic publications, over 185 technical research reports, and presenter at over 80 conferences.

Dr. Geraldine Palmer

Dr. Geraldine (Geri) L. Palmer is a community psychologist-activist, educator, and writer whose work advances African American community wellness, resilience, and health equity through culturally grounded and decolonial frameworks. She is an Assistant Professor at Adler University and co-founder of the Community Wellness Institute. She earned her PhD in Community Psychology from National Louis University. Dr. Palmer is co-editor of an open-access textbook, *Case Studies in Community Psychology Practice: A Global Lens*, and has authored and co-authored chapters in three other books, numerous articles in peer-reviewed journals, trade publications, blogs and has been featured on two podcasts. Her honors and awards include a 2026 Society for Community Research and Action (SCRA) Fellowship and the 2024 Distinguished Contribution to Practice in Community Psychology Award from SCRA.



Detailed Program Schedule

Scan the QR code or click [here](#) for a copy of the detailed schedule with presenter abstracts



DAY 2: Friday, May 22nd

*indicating primary presenter(s)

Times	Activity	Location of Activity
8:00 am – 4:30 pm	<p>Registration Desk Open</p> <p><i>Refreshments</i></p>	Foyer/Science Science Atrium
9:00 – 10:15 am	<p>Concurrent Session 1</p> <p>Session 1A: Artistic Presentations (Please see specific room numbers beside title names)</p> <p><i>Recovery Game Cafe: Autobiographical Game Design as a Creative Practice for Exploring Opioid Addiction Experiences (N1042)</i></p> <ul style="list-style-type: none"> • Sandra Danilovic, Wilfrid Laurier University • Kenny Chee, Wilfrid Laurier University • Michelle Skop, Wilfrid Laurier University <p>In response to the opioid crisis affecting communities across Canada, our community-engaged, arts-based research focused on Brantford and Hamilton, Ontario — two cities with some of the highest rates of opioid addiction in Canada. In Fall 2022, our research team organized two-day creative workshops, known as game jams, where 21 adults created digital games drawing on their lived experiences of opioid addiction. Our game jam research explores how adults with a history of opioid addiction navigate the healthcare system, experience their recovery process, and build resilience through game-based storytelling. Instead of emphasizing traditional evaluation metrics or clinical health interventions, we position the game jam as an inclusive platform that values creativity and social connection. This research, which is rooted in harm reduction principles and the community psychology values of empowerment and community, is essential for academia, policymakers, and the public to learn about how game design can be a creative tool for fighting stigma, supporting recovery, and restoring the dignity of people using drugs. We present our digital archive—www.RecoveryGameCafe.com—featuring playable games created during these game jams, along with behind-the-scenes photographs, doodles, and sketches showcasing the autobiographical game design process.</p> <p><i>Arts of Resilience: Photovoice Insights on Cultural Identity and Coping Among Indigenous and Diaspora Communities (N1042)</i></p> <ul style="list-style-type: none"> • Fatema Abdelzaher, University of Alberta • Hana Shahin, Zayed University <p>Art has been one of the most empowering tools of coping and expression for people living in crises. In current times of polycrisis, we can benefit from learning about artistic means of survival adopted by Indigenous people and members of diaspora living in Canada. This presentation shares findings from an asset-based Photovoice study examining how Indigenous and diaspora communities express identity and cope during periods of conflict and global polycrisis. Using convenience-stratified sampling, participants captured photographs that reflected their heritage, sense of belonging, memories, and everyday coping mechanisms. These images were paired with reflective narratives. Analysis identifies key protective factors, including informal community support, cultural rootedness, embodied traditions, and creative resistance, that help sustain well-being among groups facing displacement or collective trauma. Cross-community patterns further demonstrate how cultural identity serves as both an anchor and a coping mechanism during periods of instability. The presentation integrates visual data (photographs and brief participant quotes), a narrative walkthrough of the themes, and a short facilitated discussion with the audience. This approach honours community voice, supports collective interpretation, and aligns with the values of community psychology, particularly in participatory knowledge mobilization. The session concludes with reflections on culturally responsive, community-led interventions that support identity affirmation and resilience among Indigenous and diaspora communities in Canada. It offers practical implications for community partners, mental health practitioners, and researchers working in contexts of conflict, displacement, and cultural continuity.</p> <p><i>Understanding Filipino Canadian Identity and Thought to Combat the Polycrisis: Fascism, Ferdinand and Imelda Marcos, and What We Can Learn From Their Tyranny (N1042)</i></p> <ul style="list-style-type: none"> • Dion Flores, Wilfrid Laurier University <p>Come to the Filipino History and Culture Exhibit to discover how fascism took over the Philippines in the 1970s, the steps that led there, and the repercussions today. This artistic presentation will include books for perusal, Filipino cultural artifacts and weaved materials, traditional songs, and storytelling about Ferdinand and Imelda Marcos and their tyrannous reign and legacy</p>	<p>Room numbers beside title names</p> <p>N1042/N1057/N1059</p>

Perspectives Toward Liberation and Practical Implications (N1057)

- Val Masny, Université du Québec à Montréal
- Bérénice Jean, Université du Québec à Montréal
- Kai Handfield, Université du Québec à Montréal

Building on conversations in so-called Quebec around how dominant discourses of inclusion maintain status quo (Graham et Slee, 2008; Tink et al., 2020), this artistic co-creation considers the necessary conditions for liberation. Reflecting through liberation allows us to recognize everyone as a full member of the community (Long & Guo, 2023), but also to address the processes of erasure and dehumanization maintained by so-called inclusive techniques (Alexander & Berbarry, 2021).

Without real transformation of systems of oppression, inclusion means assimilation and conditional tolerance (Ahmed, 2020; Sinclair et al., 2023). It proves insufficient in protecting the rights of marginalized people. As community psychologists, we must look beyond the horizon and apply the knowledge that emerges from projects by and with diverse groups. Inclusion does not mean the same thing for everyone, nor is it experienced in the same way, but our liberation is inextricably linked. How can we apply what we have learned and chip away at systems of oppression?

This artistic presentation brings lessons learned from academics and non-academics from different backgrounds and disciplines in various forms. It invites you to interact with these lessons to find how they can fit into your practice as current and future community psychologists and bring us closer to collective liberation. From this process, we are hoping to co-create a collective zine: *Perspectives Toward Liberation and Practical Implications in Community Psychology*.

Misdiagnosis as Psychiatrist Harm: Black Autistic Youth, Polycrisis, and the Possibility of Hope (N1057)

- Nerissa Hutchinson, Toronto Metropolitan University

Canvas Painting. "Black autistic youth move through psychiatric systems where their communication, behaviours, and cultural expressions are filtered through racialized and ableist assumptions. Misdiagnosis is not just a clinical oversight, it is a socio-political act shaped by anti-Black racism and ableism across healthcare, education, and justice institutions. These systems routinely interpret Black autistic embodiment as dangerous or disordered, reinforcing what Ben-Moshe (2020) describes as the psychiatric carceral system: a network of surveillance, coercion, and institutional control that disproportionately targets racialized and disabled bodies. In the context of today's polycrisis, where institutional instability, fragmented services, uncertainty, and intensified surveillance overlap, diagnostic inequities deepen. Black autistic youth face heightened vulnerability as carceral responses to disability and Blackness escalate, amplifying mistrust and undermining safety. In alignment with *Community-Based Research and Practice in Canada and Beyond: Hope in the Times of Polycrisis*, this work highlights community-rooted strategies that cultivate possibility and transformation. Trauma-informed and culturally safe care, youth-led decision-making, intergenerational networks of support, and disability justice frameworks (Daniels et al., 2025; Reece, 2024) offer approaches that centre autonomy, dignity, and culturally grounded understanding. These strategies aim to create environments where Black autistic youth are heard, respected, and supported on their own terms. Grounded in Critical Race Theory, Critical Disability Theory, intersectionality, and Afrofuturism, this work imagines a future beyond psychiatric harm. Afrofuturism offers a vision of liberated possibilities in which Black autistic youth experience belonging, safety, and self-determined care. As Gipson (2019) notes, Afrofuturism is a tool for freedom and equality, imagining worlds that overcome ongoing inequities. Even in times of polycrisis, community collaboration offers a powerful source of hope and a blueprint for Black disabled futurity.

Where the Land Remembers Us (N1059)

- Ann Marie Beals, Wilfrid Laurier University

"Where the Land Remembers Us follows Kisu, a Two-Spirit Afro-Indigenous L'nu'k whose story weaves Land, memory, and survivance into a contemporary narrative of return. Set along a reclaimed shoreline shaped by community gatherings, ceremony, and kinship, the story explores how relationships with Land become a site of healing, belonging, and resistance. Through Kisu's journey, themes of displacement, anti-Black and anti-Indigenous violence, and the ongoing erasure of Afro-Indigenous presence surface alongside moments of deep relational care. The shoreline becomes both refuge and political space, where community members gather to sing, drum, and remember, rebuilding connections severed by colonial policies, gentrification, and forced migration. Guided by Elders, Ancestors, and the more-than-human world, Kisu learns that home is not a fixed place, but a living relationship shaped through reciprocity, Land-based practices, and collective remembering.

This presentation shares key passages and insights from the story, situating fiction as a method for community-engaged knowledge, intergenerational storytelling, and the affirmation of Afro-Indigenous identity. The story also serves as an arts-based, community-rooted research method for exploring Afro-Indigenous memory, relationship, and resurgence. By centring Land as witness and teacher, the narrative highlights how story can hold pain and possibility together, creating spaces where both healing and resurgence take root.

Key words: Afro-Indigenous Identity, Land-Based Relationships, Survivance, Arts-Based Research, Community-Engaged Storytelling, Resurgence"

Thematic Overview: Health and Housing
Session 1B: Lightning Presentations

N1001

A Point-in-Time Estimate of Client Opioid Use in a Community Mental Health Setting

Allison Soler, University of Waterloo
Maryann Roebuck, Canadian Mental Health Association Ottawa

Addressing Organizational Stigma in Electronic Health Records for People Who Use Drugs

Kaitlyn Moore, Brock University

Early Implementation of Shelter Diversion Program for Youth Experiencing Homelessness in Ottawa

* Jason Liang, Centre for Research on Educational and Community Services, School of Psychology, University of Ottawa
John Sylvestre, Centre for Research on Educational and Community Services, School of Psychology, University of Ottawa

The State of Mental Health Rights Violations in Outaouais (Québec)

Hareg Worku, University of Ottawa

The Free-Flowing Model of Faith and Spirituality: A Framework for Culturally Responsive Care

Sandra Dixon, University of Lethbridge
Millie Batta, University of Lethbridge

Between Support and Surveillance: The Care-Control Paradox in Transitional Housing for Youth

Samuel Van Wyck, Wilfrid Laurier University

Matrilineal Planning & Community Housing Alliances: Black-Indigenous Futures of Belonging and Care in a Time of Polycrisis

Kayla Webber, Toronto Metropolitan University

The Promise of Community Ownership: Case Studies in collective ownership of land and property

Scotney Evans, University of Miami
Ahmed Mori, University of Miami
De'Sean Weber, University of Miami
Gretchen Beesing, University of Miami

North American Chinatowns: Urban Perspectives on Social Coexistence

*Anna Can, Concordia University
Marcella Chiromo, Concordia University
Janie Houle, Université du Québec à Montréal

Research with Indigenous Diaspora: A Journey of Relational Accountability and Resurgence

Gretchen Mangahas, Centre for Addictions and Mental Health

Session 1C: Panel Presentation: *From Participatory Action Research to Prioritizing Actions and Relationships – Transforming Community-based Researchers*

N1002

- Andrew Spring, Wilfrid Laurier University
- Carla Johnston, Wilfrid Laurier University
- Jennifer Temmer, University of Waterloo

Participatory Action Research (PAR) is a preferred methodology for research in community settings because of the perceived benefits it offers community members. Guidance from Indigenous and non-Indigenous scholars alike prepares academics to navigate the relational web that may pull them in different directions, as they strive to do research 'in a good way'. For example, PAR frequently necessitates longer project timelines than the mainstream academic world considers acceptable. Yet, PAR and resultant research outcomes are often framed as contributing to decolonization within both communities and academia. Researchers identify their positionality and situate themselves in relation to the research context, often before and during a project. However, it remains rare for researchers to identify how engaging in PAR with community members also transforms who they become relationally outside of their academic roles. Within the Canadian context we are all treaty people and researchers have responsibilities to reconciliation beyond the academy. Within our panel, we explore how researchers' long-term partnerships have evolved from the pursuit of conventional PAR principles to the concept of Prioritizing Actions and Relationships (PAR2), both within and outside community contexts, through personal growth and the development of their student mentees as a result of PAR experiences.

10:15 – 10:30 am

Morning Break

Concurrent Session 2		
10:30 – 11:45 am	<p>Session 2A: Panel Presentation: <i>Connections in Precarity: Social Relationships Within Homelessness</i></p> <ul style="list-style-type: none"> ● Stéphanie Manoni-Millar, School of Psychology, University of Ottawa ● Konrad Czechowski, Centre for Research on Educational and Community Services (CRECS) ● Ayda Agha, MAP Centre for Urban Health Solutions, Unity Health Toronto <p>This panel brings together three presentations exploring how those experiencing homelessness navigate relationships, social support, and community connections within precarious conditions. It highlights research focused on community-based scholarship that promotes hope and resistance during crises and challenges dominant risk- and deficit-oriented approaches to homelessness.</p> <p>Throughout the presentations, panelists emphasize both the positive (bright) and negative (dark) aspects of social relationships. On the positive side, they discuss how social networks, intimate partnerships, and community ties foster a sense of belonging, trust, and pathways toward housing stability. On the negative side, they explore how limited social relationships or community connections experienced during homelessness systematically harms relational wellbeing. Structural barriers, stigma, and coercive environments hinder the ability to form and maintain safe, consensual, and supportive relationships, often leading to isolation, harm, and exclusion.</p> <p>Finally, the panel focuses on hope and future directions, asserting that although research on the social and relational dimensions of homelessness is limited, existing evidence is encouraging. The presentations incorporate community psychology frameworks—including social capital, sexual citizenship, and resilience—to inform policies, services, and interventions that promote connection, dignity, and inclusion as acts of resistance and collective care.</p>	N1001
	<p>Session 2B: Panel Presentation: <i>Community Psychology in Canada at the intersection of climate change, sustainability, and social justice</i></p> <ul style="list-style-type: none"> ● Manuel Riemer, Wilfrid Laurier University ● Jennifer Dobai, Wilfrid Laurier University ● Kaitlyn Ashmore, Wilfrid Laurier University ● Brittany Palmer, Wilfrid Laurier University ● Pariya Tofigh, Wilfrid Laurier University ● Maria Aziz, Wilfrid Laurier University <p>Climate change and other environmental destruction are among the biggest threats to human wellbeing and that of many other species on Mother Earth. Communities and individuals already marginalized by mainstream society and institutions will experience the most significant impacts of the environmental threats. Canadian community psychologists have been at the forefront of critical theoretical, empirical, and action-oriented work to address both the anthropogenic causes of these environmental changes as well as the community resilience needed to deal with the unavoidable consequences. In this panel, Canadian community psychologists will present examples of this work in action. This will include working with schools on creating cultures of sustainability and working with youth on dealing with the negative consequences of being engaged in climate activism on their wellbeing. Following the presentation of these examples, the panelists will engage in a discussion with the audience of how consideration of climate and sustainability justice can be integrated into other social justice work community psychologists are engaged in. This will become increasingly important in the time of a major polycrisis.</p>	N1002
	<p>Session 2C: Panel Presentation: <i>About Us Without Us? Remediating Lived Expertise Exclusion With Community-Engaged Reviews of Research and Policy</i></p> <ul style="list-style-type: none"> ● *Scott Neufeld, Brock University ● *Tia Greto, Brock University ● Molly Nullmeyer, Brock University ● *Emily Spanton, Brock University ● Lana Richardson, Brock University <p>In times of polycrisis, researchers, policy makers, and people who hold power cannot afford to ignore the voices and perspectives of people with lived and living expertise. Meaningful inclusion, empowerment and collaboration of and with directly impacted community members is essential for avoiding ethical missteps, enhancing scientific rigor, and anchoring policy ideas and implementation in the realities of the people they affect. This panel will showcase three innovative examples of how researchers worked collaboratively to elevate the situated lived expertise of residents of a heavily-researched neighborhood, front line community mental health service workers, and people who use illicit drugs (PWUID). Neufeld et al report on the formation of an independent community research ethics review process in Vancouver's Downtown Eastside. Greto et al describe a systematic policy review of MAID policy discourse and mental health inequities informed by frontline workers. Shahid et al present findings from a community based participatory research (CBPR) project asking PWUID to share their perspectives on drug policies. Through independent community ethics review, stakeholder consultation, and CBPR, these three talks showcase different strategies for how the exclusion of lived expertise can be remedied, when situated wisdom is needed more than ever.</p>	BA111

	Session 2D: Workshop Presentation: <ul style="list-style-type: none"> - Elizabeth Brunet, Université of Québec in Montréal (UQAM) - François Lauzier-Jobin, Université of Québec in Montréal (UQAM) 	BA110
11:45 - 12:45 pm	Lunch (catered)	Science Atrium
12:45 pm - 1:15 pm	Poster Presentation Session A Posters will be displayed for the entirety of the conference. Presenters will be available at their posters during the designated poster sessions. Please refer to <i>Poster Session A</i> and <i>Poster Session B</i> in the schedule to see which presenters will be available in each session. <p><i>Relational Research through Indigenous Storywork: Principles and Practices</i> Ryan Neepin, Faculty of Education, Wilfrid Laurier University</p> <p><i>Perceptions of Black Middle School Students' School Belonging: Exploring Related Factors and Influences</i> Margaret Douglin, Wilfrid Laurier University</p> <p><i>The Role of Family Community Organizations in Shaping a Supportive Ecology Around English-Speaking Families in Quebec</i> Yami-Louise Djoudi, Fédération Québécoise des Organismes Communautaires Famille Liesette Brunson, Université du Québec à Montréal (UQAM)</p> <p><i>Equity in Every Cycle: Community Insights from a Menstrual Equity Pilot Program at Wilfrid Laurier University</i> Eden Hennessey, Wilfrid Laurier University Angela Demarse, Karly Rath, Wilfrid Laurier University Katlyn Melcher Skye Hennessey, Wilfrid Laurier University Alessandra Gargiulo Hayley Newman-Petryshen</p> <p><i>Preventative Care Through Psychology, Trauma and Oral Health</i> Anna R. Muller, Adler University, Chicago, IL</p> <p><i>Learning Emotion Focused Therapy for Youth: Clinician Experiences Across A Two-Day Training</i> Amy Zucchetti, Emotion Transformation Institute, Family Care Centre</p> <p><i>Cognitive Accessibility of Health Resources</i> Niima Er-raji, University of Ottawa, Open Collaboration for Cognitive Accessibility</p> <p><i>"This is a Societal Issue Not Just a Womxn's Issue"- Addressing the Impact of Vicarious Trauma in in Womxn-Dominated Nonprofit Gender-based Violence Services</i> Nat Hasulyo, Centre for Community Research, Learning and Action, Wilfrid Laurier University, SASC</p> <p><i>The Perception of Mental Health Resource Accessibility Among Youth Convicted of an Offence in Canada and the United States: A Scoping Review</i> Jenna Sykes, University of Guelph</p> <p><i>Facing Climate Change in Canada</i> Leanne Lacap, Centre for Addiction and Mental Health (CAMH)</p> <p><i>Carrying the Past, Navigating the Present: Indigenous Youth Perspectives on Foster Care and Homelessness</i> Sareh Salehi Toka, Wilfrid Laurier University</p>	Science Atrium
1:15 - pm - 2:30 pm	Concurrent Session 3 Session 3A: Panel Presentation: Solutions to Homelessness: Research on Housing First Program Adaptations <ul style="list-style-type: none"> ● Maritt Kirst, Wilfrid Laurier University ● Geoff Nelson, Wilfrid Laurier University; End Homelessness Winnipeg Housing First Collaborative ● Victoria Rozycki, Wilfrid Laurier University ● Shannon Watson, Wilfrid Laurier University; End Homelessness Winnipeg Housing First Collaborative ● Margaret Douglin, Wilfrid Laurier University 	N1001

Homelessness continues to be a serious social and health problem in Canada. Recent Canadian point-in-time counts have shown an increase in the number of people experiencing homelessness on any given night by 20% since 2018. Housing First is an evidence-based, effective supported housing program designed to address the needs of individuals experiencing homelessness and mental illness. The program provides permanent housing without prerequisites for abstinence or treatment, and access to health and social services. An important area for future research is on effective adaptations of the HF model to respond to changing needs (e.g., complexity of clinical service and housing type needs) of specific populations experiencing homelessness. These three presentations will discuss evaluative findings from two different Housing First program adaptations for youth and Indigenous peoples experiencing homelessness in Canada.

Session 3B: Panel Presentation: *Advancing Social Prescribing in Canada: Evidence from Practice, Theory, and Policy*

N1002

- Kyra Simons, Wilfrid Laurier University
- Le-Tien Bhaskar, Department of Health Research Methods, Evidence, and Impact (HEI), McMaster University
- Sarah Feeney-Martin, Link2Wellbeing Program, Older Adults Centres' Association of Ontario
- Grace Higgins, Alliance for Healthier Communities

Canada's population is aging, and older adults are increasingly reporting being socially isolated. As such, there is a need to promote social connectedness in older adults. Participating in community programming fosters social connection while also promoting agency, strength, resilience, and mental health and wellbeing among older adults. One way that folks become engaged in community programming is through social prescribing; a comprehensive, person-centered approach that connects people to non-clinical supports. We present 3 talks regarding the impact of social prescribing movements in Ontario and beyond. First, the Older Adults Centres' Association of Ontario presents an in-depth overview of social prescribing and its use amongst older adults through their Links2Wellbeing project. Next, Simons will summarize these works together through sharing her emerging research on the impact of racial and older age identity integration on community program engagement, with a specific focus on cultural fit and accessibility. Lastly, Bhaskar will present an environmental scan of healthcare policy across Canada and highlight themes which exemplify and/or promote the integration of social prescribing into mainstream healthcare.

Session 3C: Workshop Presentation: *Stories Across Space & Time: Reflections on Thirty Years of Community Psychology Practice in Canada, Ghana, & Trinidad and Tobago*

BA110

- Cari Patterson, National Louis University, USA; Acadia University, Canada
- Charity S. Akotia, University of Ghana, Legon, Accra
- Colleen Davis, Veni Apwann, Trinidad and Tobago

Thirty years after graduating from WLU's Community Psychology (CP) program, we—three alumnae from the class of 1993—will share the stories of how CP has shaped our work and identities across three countries and multiple sectors. Beginning with our shared experiences in the program, we will trace how those early foundations carried forward and took form in our professional lives: Cari in Canada, Charity in Ghana, and Colleen in Trinidad and Tobago.

Together, we will visualize how CP theories, values, and tools have been adapted, challenged, and re-imagined across place, time, and practice.

Using a collaborative storyboard as both method and structure, we will map key moments, highlights, lessons, tensions, and successes from three decades of practice in community, academic, private, and multisectoral settings. This shared mapping process will illuminate convergences in our careers—such as commitments to equity, relational and participatory ways of working, systems thinking, and community-led knowledge—as well as divergences shaped by distinct cultural, political, and institutional contexts in the countries where we live and work.

The session intentionally models collective sensemaking. Rather than presenting a completed narrative, we will construct the storyboard in real time, inviting participants to contribute reflections, questions, and parallels from their own CP experiences. As contributions accumulate, the storyboard becomes a living learning artifact that represents both our journeys and the collective insight of the room.

Drawing on this shared wisdom, we will identify themes that cut across our alumni careers and co-generate insights about the evolution of CP practice. We will close by inviting participants to help articulate implications for future Community Psychology education and for the ongoing development of WLU's CP program.

2:30 pm - 2:45 pm

Afternoon Break
Refreshments

Science Atrium

Session 4A: Panel Presentation: *Breaking Barriers: Community-Based Research for Disability-Inclusive Employment*

N1001

- Michelle Willson, Canadian Council on Rehabilitation and Work (CCRW)
- Dr. Vanessa Sinclair, Canadian Council on Rehabilitation and Work (CCRW)
- Jeffrey Normore, Canadian Council on Rehabilitation and Work (CCRW)

Work is a social determinant of health which facilitates access to resources, improves quality of life, and promotes physical and psychosocial wellbeing. However, people with disabilities in Canada face employment inequities, including higher rates of unemployment, underemployment, and precarity, as well as income disparities. These inequities are driven by persistent, systemic barriers like bias and stigma, inaccessible workplaces, and institutionalized ableism. The theme of our panel is employment access for persons with disabilities, showing how community-based research is crucial to addressing labour market barriers and promoting accessible, inclusive work in Canada.

CCRW is the only national non-profit organization dedicated to promoting employment equity and inclusion for people with disabilities. CCRW offers employment services for jobseekers with disabilities, provides resources and training to employers, and conducts community-based, participatory research on disability and work. Three panelists will share findings from two of CCRW's community-based research initiatives, discuss our approach to community engagement and participation, and show how our research informs our service delivery and innovative resources for disability communities.

Session 4B: Panel Presentation: *Lived Expertise Engagement for Housing Justice*

N1002

- Sarah Ranco, Wilfrid Laurier University, Social Development Centre Waterloo Region
- Leah Connor, Social Development Centre Waterloo Region
- Emily Escoffery, Wilfrid Laurier University
- Manuel Riemer, Wilfrid Laurier University
- Julian Ichim, Lived Expertise Engagement Program, Social Development Centre Waterloo Region
- Ashley Hynd, Lived Expertise Engagement Program, Social Development Centre Waterloo Region
- And other members of the Lived Expertise Engagement Program

The Social Development Centre Waterloo Region (SDC) is a non-profit that supports the creation of community wide solutions, ensuring that lived experience is the basis for collective action towards change in policies and service delivery, particularly in the realm of housing justice. SDC staff seek to have their advocacy remain grounded in authentic and direct connections to the knowledge of some of the most underserved populations. To do this, they have prioritised building long-term relationships with community connectors and ensuring support that can sustain lasting involvement. This has culminated in the Lived Expertise roster, a group of 35+ members with lived experience of housing marginalization or homelessness, experience with systems advocacy experience, and/or formal connections to grassroots groups or underrepresented communities. This panel highlights the different spaces where the roster is most involved, including government processes, academic research, and on-the-ground activism. Across all presentations, this panel examines what it means to authentically engage with those with lived experience and how to sustain advocacy efforts through long-term commitments and support.

Session 4C: Workshop Presentation: *Ecological praxis and the future of community psychology : strategies, competences and ways to incorporate ecological system in our practices, teaching and professional development*

BA111

- Elizabeth Brunet, Université of Québec in Montréal (UQAM)
- Liesette Brunson, Université of Québec in Montréal (UQAM)

Community psychology in Canada has a strong tradition of theory and value-driven work on ecological systems, equity, and community engagement. The use of ecological frameworks have become a trademark of community psychology both on ways to understand and intervene in complex systems. Yet, there is limited empirical knowledge or guides about the practical competences that community psychologists actually mobilize when we intervene in ecological systems and support collective action. This gap in knowledge leaves us with questions on the training of community psychologists and the concrete skills required to design, advocate for, and implement collective interventions with communities and organizations within an ecological approach and community psychology values and traditions.

Thus, this workshop constitutes the first step in a broader participatory study aimed at documenting the competences and strategies that practitioners consider essential for ecological intervention in community psychology. The session will invite participants—students, professors, graduates, and community practitioners—to collectively identify and organize the practices that are used to shift systems, redistribute power, and strengthen local ecologies of support as well as types of change these practices aim to achieve.

Participants will take part in an interactive brainstorming process to identify: (1) strategies most commonly used in the field (2) competences that new community psychologists need to feel prepared to propose and lead such strategies (3) concrete ways to incorporate community psychology values in praxis and complex settings.

The goal is to produce an initial collective list of competences that reflects the realities of practice across diverse community contexts and to understand the actualization of ecological systems in praxis.

The workshop will generate outcomes that feed directly into future research and practice and eventually a practice-informed competency framework to support teaching, practicum supervision, and professional development in ecological focused interventions.

4:00 pm - 5:00 pm	Waterloo Community Spotlights O:se Kenhionhata:tie Land Back Camp Social Development Centre Waterloo Region Centre for Community Based Research	Foyer
-------------------	---	-------

Saturday, May 23rd 2026

Times	Activity	Location of Activity
-------	----------	----------------------

8:00 am – 4:30 p	Registration Desk Open <i>Refreshments</i>	Foyer/ Science Atrium
------------------	---	-----------------------------

9:00 – 10:15 am **Concurrent Session 5**

9:00 – 10:15 am	<p>Session 5A: Workshop Presentation: <i>Workshopping World-Building: Abolitionist feminist pedagogical tools</i></p> <ul style="list-style-type: none"> • Nealob Kakar, University of Guelph <p>Current disciplinary models of doing research <u>tends</u> to separate matter from perception, leading to “a fragmentation between awareness and the activity that generates awareness” (Springgay & Zaliwska, 2015. p. 136). Traditional language-oriented methods have not always been able to fully engage with specific groups in society, namely equity deserving communities. Given this, this workshop will explore the ways that creative worldbuilding methods can act as a catalyst for transformative community research. Drawing on a research-creation project exploring the mutual aid practices of Queer, Transgender, Black, Indigenous, People of Colour (QTBIPOC) Survivors of Gender Based Violence, this workshop will foreground zine-making as a feminist pedagogical tool and design fiction as an abolitionist worldbuilding method. Zine-making will be used as an emergent and affective process to materially piece together new understandings, counter-narratives, aesthetic engagement, and embodied sense making processes. Through practical method experimentation, the workshop aims to demonstrate the ways that worldbuilding methods can help awaken critical consciousness through liberatory imaginaries due to its “creative, imaginative, anti-oppressive, participatory, and action-oriented” nature (Osei-Kofi, 2013, p. 149).</p> <p><u>Learning objectives:</u></p> <ol style="list-style-type: none"> 1. To contribute to emerging conversations about the importance of using beyond text methods to engage with equity deserving communities, specifically as a worldbuilding practice for QTBIPOC Survivors. 2. To consider how abolition feminisms can help better shape critical arts-based participatory interventions in community-based research. 3. To demonstrate theoretical and practical understandings of research-creation as a creative practice and speculative process. 	BA110
-----------------	---	-------

	<p>Thematic Overview: International and Diverse Communities</p> <p>Session 5B: Lightning Presentations</p> <p><i>Community Perspectives on Substance Use within the Caribbean population in the GTA</i> Jayashri Maraj, Wilfrid Laurier University Ciann Wilson, Wilfrid Laurier University</p> <p><i>An Arts-Based Process Evaluation of AFRO's Support Through the Generations Program</i> Adelaide Swanston, Wilfrid Laurier University</p> <p><i>Engaging Transformative Interdisciplinary and Intersectional Approaches in Community-Based Research in the African Diaspora</i> Leo Wilton, State University of New York at Binghamton</p> <p><i>Caregiver Engagement with the Culture of Sustainability at a Multicultural School</i> Pariya Tofigh, Wilfrid Laurier University</p> <p><i>Mental Health Experiences of International Students: The Effects of Status and Migratory Policy Change</i> *Joseph Takao Bachar, University of Ottawa Soumahiya Nassrine Koné, University of Ottawa Lehna Schmidt, University of Ottawa Dr. Émilie Pigeon-Gagné, University of Ottawa</p> <p><i>The Implications of Climate Change for the Learning and Development of Children and Youth Experiencing Poverty: Evidence from Educational Contexts</i> Jolly Noor, Centre for Addiction and Mental Health</p>	N1001
--	---	-------

	<p>Scholarship as Survival: Black Women Law Professors and Critical Interventions in Times of Crisis Cherie Daniel, University of Toronto (OISE) Department (Social Justice Education)</p> <p>Schooling at the Margins: Anti-Racist Perspectives on Roma Youth, Exclusion, and Belonging Sharon Molnar, Toronto Metropolitan University Jennifer Skwarczynski, Toronto Metropolitan University Kendra Prescod, Toronto Metropolitan University</p> <p>Session 5C: Panel Presentation: Studying Up and Fighting Back: Community-Engaged Research and Action Supporting People Experiencing Homelessness in St. Catharines, ON</p> <ul style="list-style-type: none"> ● Scott Neufeld, Brock University ● Sami Jo Phillips, Brock University ● Tinashe Buckenham Dziva, Brock University ● Alan Mbadiwe, Brock University ● Pilar Dietrich, Brock University ● Emily Spanton, Brock University <p>Ontario’s housing crisis has never been worse, and the harmful effects of homelessness are only exacerbated by community stigma and the policies and political rhetoric that seek to exclude, punish and scapegoat people who are unhoused. How can research be a useful intervention in this context? Rather than amassing more stories of the harmful effects of stigma, homelessness, and exclusion, these three presentations describe collaborative, community-engaged efforts to 1) better understand how local public discourse on people who are unhoused can help justify their exclusion but also encourage greater inclusion (Phillips & Neufeld), 2) show how local policy changes impacting people experiencing homelessness also shift the language and arguments people use when bending the ear of local municipal officials (Buckenham Dziva et al), and 3) provide tangible supports (a community-informed map that reveals where encampments are allowed under a new bylaw) for people experiencing homelessness to better navigate their shifting legal environment (Neufeld, et al). All three projects demonstrate how research that is informed by community advocates and people with lived expertise , and that “studies up” to examine the structures of power in policy and discourse, can also actively contribute to anti-stigma advocacy and mutual aid for people who are unhoused.</p>	N1002
10:15 – 10:30	Morning Break	Science
10:30 – 11:45 am	Concurrent Session 6	
	<p>Session 6A: Panel Presentation: Awareness to Action: Understanding employers' motivations for building disability confidence</p> <ul style="list-style-type: none"> ● Alexis Buettgen, Wilfrid Laurier University ● Vanessa Sinclair, Canadian Council on Rehabilitation and Work (CCRW) ● Emily Escoffery, Wilfrid Laurier University ● Erin Dekker, Wilfrid Laurier University ● Rebecca Thomas-Kahn, Wilfrid Laurier University <p>An estimated 741,000 Canadians with disabilities remain unemployed despite having the capacity to work. This inequity contributes to persistent socioeconomic marginalization, reduced wellbeing, and barriers to full community participation. Simultaneously, many Canadian small and medium-sized enterprises (SMEs)—especially in critical and emerging sectors addressing the polycrisis such as health and social care, digital technologies, clean energy, agri-food, and creative industries—face significant labour shortages. These parallel challenges highlight a systemic mismatch between community resources and community needs. From a community psychology perspective, addressing this gap requires attention to structural barriers, organizational contexts, and promotion of inclusive settings that enhance empowerment and equity.</p> <p>The proposed presentation shares findings and insights from a multi-phase community based participatory action research project designed to understand and strengthen facilitators of disability inclusion within Canadian SMEs. By collaborating with employers and community partners, we are developing theoretical and evidence-informed strategies to increase disability-inclusive hiring. Our research responds to critical gaps at the intersection of disability studies, community psychology, and mixed method analyses of disability employment. In doing so, it aims to build more equitable labour market environments, mobilize strengths, and support social and economic participation for people with disabilities where data, theory, and action are urgently needed.</p>	N1002

Session 6B: Panel Presentation: *Working Alongside Peer Researchers for Epistemic Justice: Examples from the Research Chair on the Reduction of Social Inequalities in Health*

- Éric Audet, Université du Québec à Montréal (UQAM), Research Chair on the Reduction of Social Inequalities in Health (RSIH)
- Jacob Castonguay, Université du Québec à Montréal (UQAM), Research Chair on the Reduction of Social Inequalities in Health (RSIH)
- Max Dufaud, Université du Québec à Montréal (UQAM), Research Chair on the Reduction of Social Inequalities in Health (RSIH)
- Charlotte Fournier, Université du Québec à Montréal (UQAM), Research Chair on the Reduction of Social Inequalities in Health (RSIH)
- Gabrielle Lafontaine, Université du Québec à Montréal (UQAM), Research Chair on the Reduction of Social Inequalities in Health (RSIH)

Across community psychology, peer research has gained visibility, yet many projects continue to rely on limited advisory or task-based models that restrict the power and influence of people with lived experience. This panel draws on the practice framework developed at the Research Chair in the Reduction of Social Inequalities in Health (RSIH), where peer researchers with lived experiences of poverty are integrated as full partners throughout the research process. The RSIH Research Chair framework is structured around ten principles that support equitable collaboration, shared decision-making, and epistemic justice. The panel will start with a presentation describing the practices of RSIH Research Chair in Montreal, Québec. Four practical examples of projects lead alongside peer researchers will then be presented, in diverse spheres related to health equity, including housing instability, alternative food networks, citizen participation in public housing and public welfare income support.

BA110

Session 6C: Workshop Presentation: *Opening Space for Applied Theatre in Community Research*

- Heather Majaury, Outta Work Actors (not-for-profit)
- Laura Pin, Wilfrid Laurier University

This interactive workshop introduces participants to the use of applied theatre. Building on the techniques developed by Outta Work Actors (OWA), the session explores how participatory performance practices can open space for dialogue, reflection, and transformative engagement with social issues. OWA is a non-profit theatre collective, with a focus on deep engagement with narratives that capture diverse experiences, challenges, and triumphs, and foster a sense of belonging, unity and shared purpose. Their current focus is in growing their Two Minute Play Laboratory.

Inspired by the applied theatre principles of Augusto Boal, Playback Theatre, and diverse improvisational traditions, the Two Minute Play Laboratory uses a system of responsive, rapid dramaturgy to illuminate everyday encounters with housing insecurity, structural inequality, and social exclusion. Over the past two years, the Laboratory has collaborated with local story holders, including people with lived experience of homelessness, frontline workers, and community advocates, to co-create short dramatizations. These pieces are participatory: they invite audience members to step into scenes, rewrite possibilities, and collectively imagine alternatives, fostering both personal and systemic awareness while drawing on imagination and embodied expression as forms of knowledge. Recently, OWA has begun experimenting with how applied theatre methodologies can be mobilized within policy contexts, investigating how performance-based techniques might complement traditional research methods by surfacing tacit knowledge, amplifying lived expertise, and helping policy practitioners more deeply engage with issues of housing justice.

In this workshop led by the Artistic Director of OWA, participants will:

- Learn about the foundations of applied theatre and its relevance for community-engaged scholarship;
- Participate in some applied theatre techniques;
- Reflect on the possibilities and limitations of applied theatre as a participatory methodology for social change.

The workshop will weave in archival stories from the laboratory that were dramaturgically transformed through the same process we will demonstrate. Participants will leave with insights into how applied theatre can support relational, and community-driven approaches to research, policy and knowledge mobilization.

BA111

**Thematic Overview: Mics./Relationships and Sexual Diverse Communities
Session 6D: Lightning Presentations**

Appropriate Terminology in Research: Working with Transgender and Gender Diverse Populations

*Cyrus Price, University of Ottawa
Caroline Vonlanthen, University of Ottawa
Konrad Czechowski, University of Ottawa

How 2S/LGBTQ+ individuals experience talking about sexuality and gender with CisHet people

Sophie Landry, Wilfrid Laurier University

N1001

Creating Affirming Spaces for Transgender and Non-Binary Individuals During In-Person Research

Selena Houmani, Centre for Research on Educational and Community Services, University of Ottawa
Caroline Vonlanthen, University of Ottawa
Konrad Czechowski, University of Ottawa

Building Research Capacity in Community-Based Organizations: A case study with MAX Ottawa

*Selena Houmani, Centre for Research on Educational and Community Services, University of Ottawa
Olivia Onesi, Centre for Research on Educational and Community Services, University of Ottawa
Adam Awad, Centre for Research on Educational and Community Services, University of Ottawa
Ahmed Muslimani, Centre for Research on Educational and Community Services, University of Ottawa
Antonio Wilson, Centre for Research on Educational and Community Services, University of Ottawa
Konrad Czechowski, Centre for Research on Educational and Community Services, University of Ottawa

Navigating serious mental illness and the liminal space created by being a 'patient' and researcher

Julia Jozkow, Wilfrid Laurier University

Centring Survivor Voices: Intersectional Pathways to FGM/C and Mental Health Equity

Dunia Azarra, Toronto Metropolitan University

Whose Evidence Counts? Aligning Peer Support With Community-Based Research to Resist Co-optation

Allison Dunning, Peer Support Canada, Canadian Mental Health Association National

Responding to Crises: What is the Value of Community-Based Research?

Amanda Demmer, Community-Based Research Canada
Lukas Salib, Community-Based Research Canada

11:45 am -
12:45 pm

Lunch (catered)

**Science
Atrium**

12:45 pm - 1:15
pm

Poster Presentation Session B

Posters will be displayed for the entirety of the conference. Presenters will be available at their posters during the designated poster sessions. Please refer to *Poster Session A* and *Poster Session B* in the schedule to see which presenters will be available in each session.

Understanding and Addressing Eco-Anxiety Among Youth: Insights from a Scoping Review and Community Psychology Perspective

Jennifer Dobai, Wilfrid Laurier University, Community Psychology
Livia Dittmer, Viessman Centre for Engagement and Research in Sustainability (VERiS)
Manuel Riemer, Viessman Centre for Engagement and Research in Sustainability (VERiS)

Where Community Meets Environment: Insights from a Preliminary Study of Sustainable Placemaking

Liesette Brunson, Université du Québec à Montréal
Mary-Jane Baldwin, Université du Québec à Montréal

Using Community-Based Research to Kickstart Grassroots Organizing and Advocacy: A Niagara Case Study

Scott Neufeld, Brock University
Emily Spanton, Niagara Advocates with Lived and Living Experience (NALE)

"I just want my kid to have a normal life": paradoxes of care among providers and families of transgender and gender-diverse youth in Brazil

Julia C Pontes, University of Toronto
Lori Ross, University of Toronto
Rosana Machin, University of Toronto

"The world is really not built for everyone": A qualitative investigation of suicide risk among autistic transgender and gender diverse adults and the essential role of health care providers

*Erin Dekker, Wilfrid Laurier University
Annabelle M. Mournet, Rutgers, The State University of New Jersey
Ellen Wilkinson, Rutgers, The State University of New Jersey
Erin Libsack, Rutgers, The State University of New Jersey
Vanessa H. Bal, Rutgers, The State University of New Jersey
Evan M. Kleiman, Rutgers, The State University of New Jersey

**Science
Atrium**

Memes as Method: Exploring Alternative Tools to Engaging Youth in the Future of Sex Education

Moni Sadri, Wilfrid Laurier University

Improving Indigenous self-government: A collaborative case study with Bədzi ʔehdá First Nation

*Nicole Burns, Balsillie School of International Affairs, University of Waterloo

David Codzi, President of Ayoní Keh Land Corporation, Member of Behdzi Ahda First Nation

The Art of Community: Community as an Act of Rebellion in Times of Polycrisis

Ariana Behroozi, Toronto Metropolitan University

1:15 pm - 2:30 pm

Concurrent Session 7

Thematic Overview: Youth/Education

Session 7A: Lightning Presentations

Going beyond the transactional nature of community service-learning (CSL): Exploring relationships in community as a site of mutual learning and justice-doing

Lisa Jarvis, Wilfrid Laurier University, Community and Workplace Partnerships

A Narrative Review of School-Based Mental Health Interventions

Makayala Halloway, University of Prince Edward Island

Community-Driven Resistance: Reimagining Youth Justice in Challenging Times

Denise Sinclair, Toronto Metropolitan University

Identity Under Pressure: Digital Nurture

Misha McRae, Toronto Metropolitan University

Kwesi Daniel, Toronto Metropolitan University

BA111

Session 7B: Panel Presentation: *Reimagining Child and Youth Advocacy Centres in Canada*

- Rachel Scott, Toronto Metropolitan University, School of Child and Youth Care
- Sarah Cardenas, Toronto Metropolitan University, School of Child and Youth Care

Child and Youth Advocacy Centres (CYACs) in Canada were created to reduce system-induced trauma by coordinating responses to child abuse, yet their operations remain tightly embedded with police and child welfare agencies. This alignment often prioritizes criminal investigation and procedural compliance over psychological safety, voluntary participation, and culturally responsive support, especially for Black, Indigenous, and other marginalized families who have experienced prior institutional harm. Drawing on policy analysis, empirical research on CYACs, and comparative models such as the Nordic Barnahus, this presentation introduces a revised CYAC model grounded in independent, rights-based advocacy rather than carceral logics. We outline a proposed Toronto-based pilot that would operate structurally independent from police and child welfare, provide advocacy across systems including education, housing, mental health, and immigration, and embed trauma-informed, anti-oppressive practice as core organizational infrastructure. The presentation will explore the practical architecture of the proposed model, including the configuration of an independent, community-governed centre in Toronto, core service pathways, and the roles of advocates, mental health practitioners, and allied partners in day-to-day practice. We will invite dialogue on how community psychologists, practitioners, and advocates can support the development, evaluation, and scaling of non-carceral advocacy models that redistribute power toward children, youth, and families most affected by institutional harm.

BA110

	<p>Session 7C: Workshop Presentations: <i>Raising critical consciousness of colonialism as First Peoples: An interactive workshop on the process and the results of a partnership study</i></p> <ul style="list-style-type: none"> • Kai Handfield, University of Quebec in Montreal <p>This interactive workshop will re-create part of a knowledge sharing/knowledge mobilization weekend that was organized with the people involved in the research, Indigenous youth doing conscientization work with (mainly white) settlers. This immersion will aim to share both the results, and the process of sharing and applying that knowledge with the people it might benefit from first. Furthermore, this will demonstrate and push conversations on how we go beyond knowledge sharing, by taking action and answering to the needs expressed in the research process. In other words, how do we respect, honour and take responsibility for that knowledge? This aims to be a space focused on action and concrete examples, to inspire further concrete actions beyond good intentions and principles.</p> <p>Concretely, this will be a form of artistic, four-wall poster presentation, where various outputs that were shared and made for the ambassadors will be exposed. For instance, memes on white fragility, excerpts from verbatims of settlers after following a workshop on colonialism 101, and infographics on microaggressions. In terms of accessibility, most of this content will be visual, and the text will be in French. I can offer translation and description in the room. The research project and context will be briefly presented, then attendees will be given some time to wander around the room, before I further explain my process and reflections. The intention is to have ample time for interactions and discussions at all stages. Prompts will be prepared to nourish concrete actions from the attendees, in terms of knowledge sharing and giving concrete tools to the communities we work with.</p>	BA112
2:30 pm - 2:45 pm	<p>Afternoon Break</p> <p>Refreshments</p>	
2:45 pm - 4:00 pm	<p>Collective Reflection II - World Cafe - <i>Reinvigorating CP Network in Canada and Beyond</i></p> <ul style="list-style-type: none"> • Dr. Leo Wilton, Department of Human Development at the State University of New York at Binghamton • Dr. Rich Janzen, Centre for Community Based Research • Dr. Geraldine Palmer, Adler University <p>The World Cafe will bring conference attendees together to reflect on what they have learned throughout the conference, using this closing reflection space to think collectively about what meaningful action looks like in the midst of the polycrisis. We invite attendees to collectively explore what our responsibilities are as researchers, practitioners, community members and to imagine how we can collaborate in our networks to carry this momentum forward and sustainably support one another as we part ways.</p>	Science Atrium
4:00 pm - 4:30 pm	<p><u>Info Session for the 11th Annual International Conference of Community Psychology</u></p> <ul style="list-style-type: none"> • Moshood Olanrewaju, 2026 ICCP Lagos, Conference Chair <p>Closing</p>	Science Atrium